

Floor Monitor Stand (Quad)

Assembly Guide

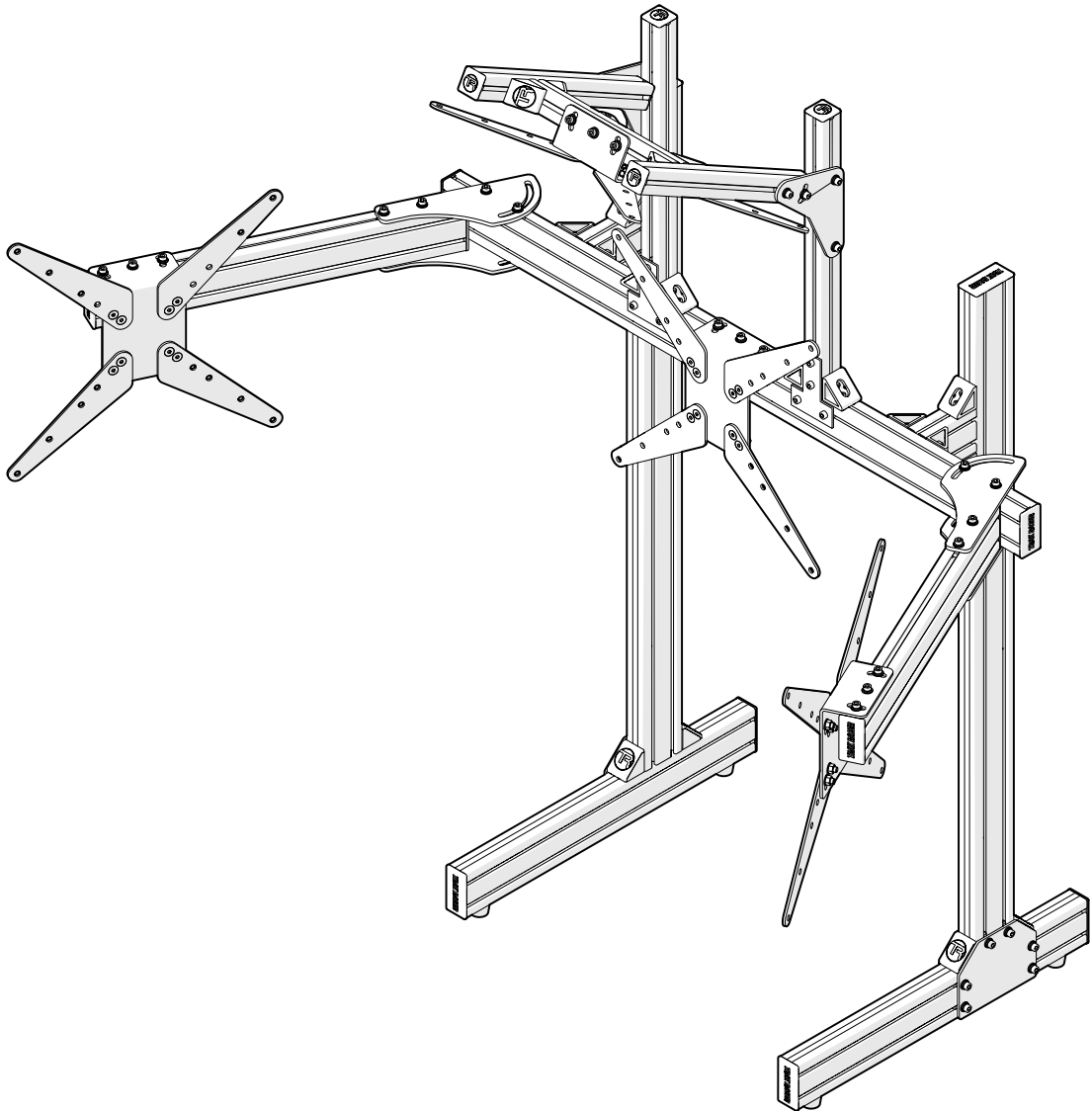

IMPORTANT: As there are different versions of each rig depending on your region, please ensure that you are using the correct instruction set. The part number below should match the part number labeled on your box

MS-FM-QD



TRAK RACER

Published 2023-09-06

TABLE OF CONTENTS

3 Symbol Legend

4 Part list

5 Assembly Notes

9 MS-SML-FM Assembly Instructions

17 TR80-TMARM4-BLK Assembly Instructions

21 TR80-4M4-BLK Assembly Instructions



IMPORTANT: As there are different versions of each rig depending on your region, please ensure that you are using the correct instruction set. The part number below should match the part number labeled on your box



IMPORTANT: Due to the nature of cut aluminium profile, some metal shavings may still be present after our extensive QA cleaning process. We recommend that boxes and packaging is opened on a hard floor.



NOTE: Some screws and washers are pre-installed. These will be part of the parts list and will need to be loosened and reattached according to the instructions.



Two people needed



Tighten hardware



Leave hardware loose for adjustment

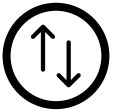

Make Adjustment



Break tab off Corner bracket CB1



Safety glasses needed



Attention / Priority



Reserve for following step



Mirrored Components (Same on both sides)

MS-FM-QD

PARTS LIST

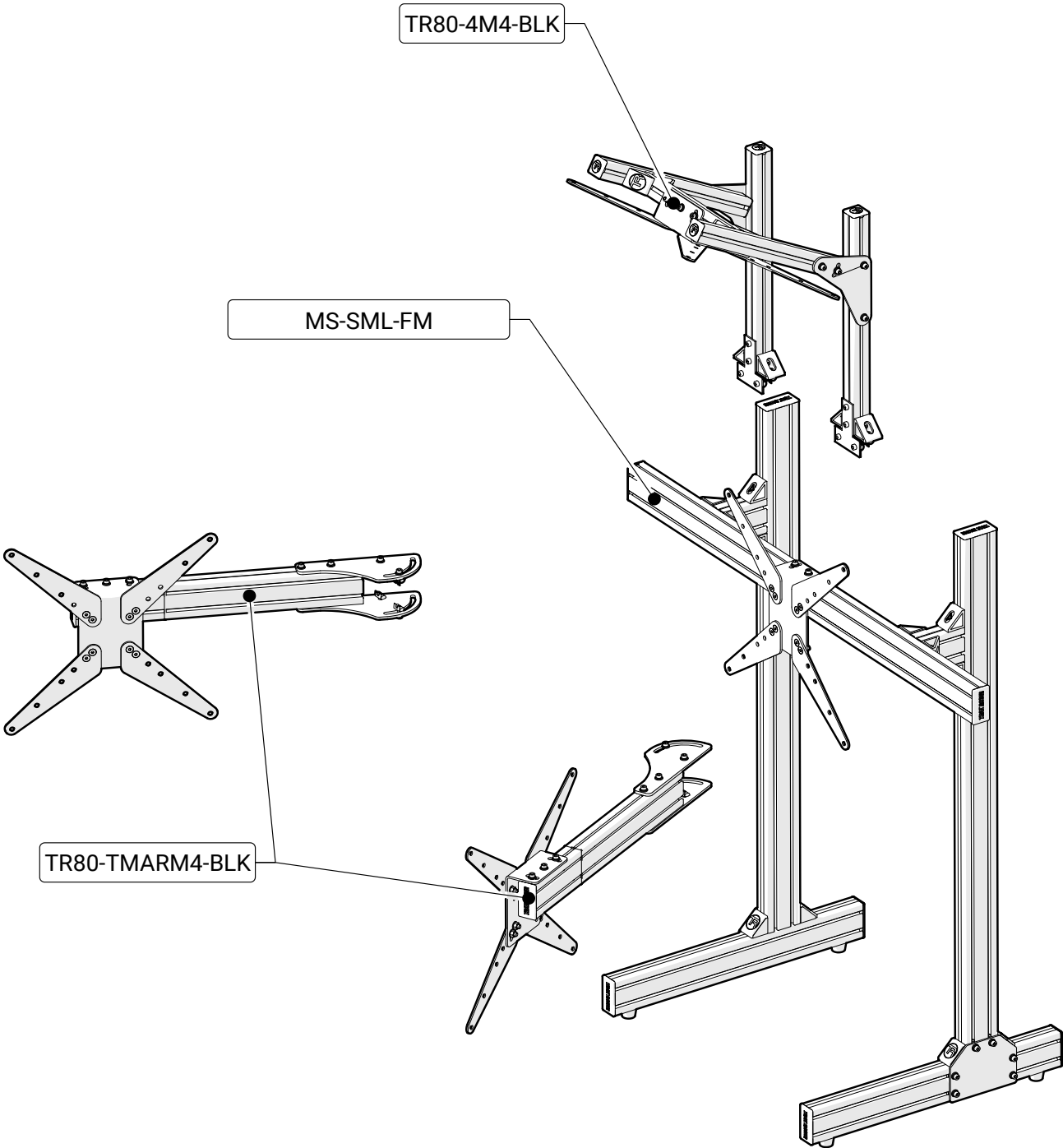

NOTE

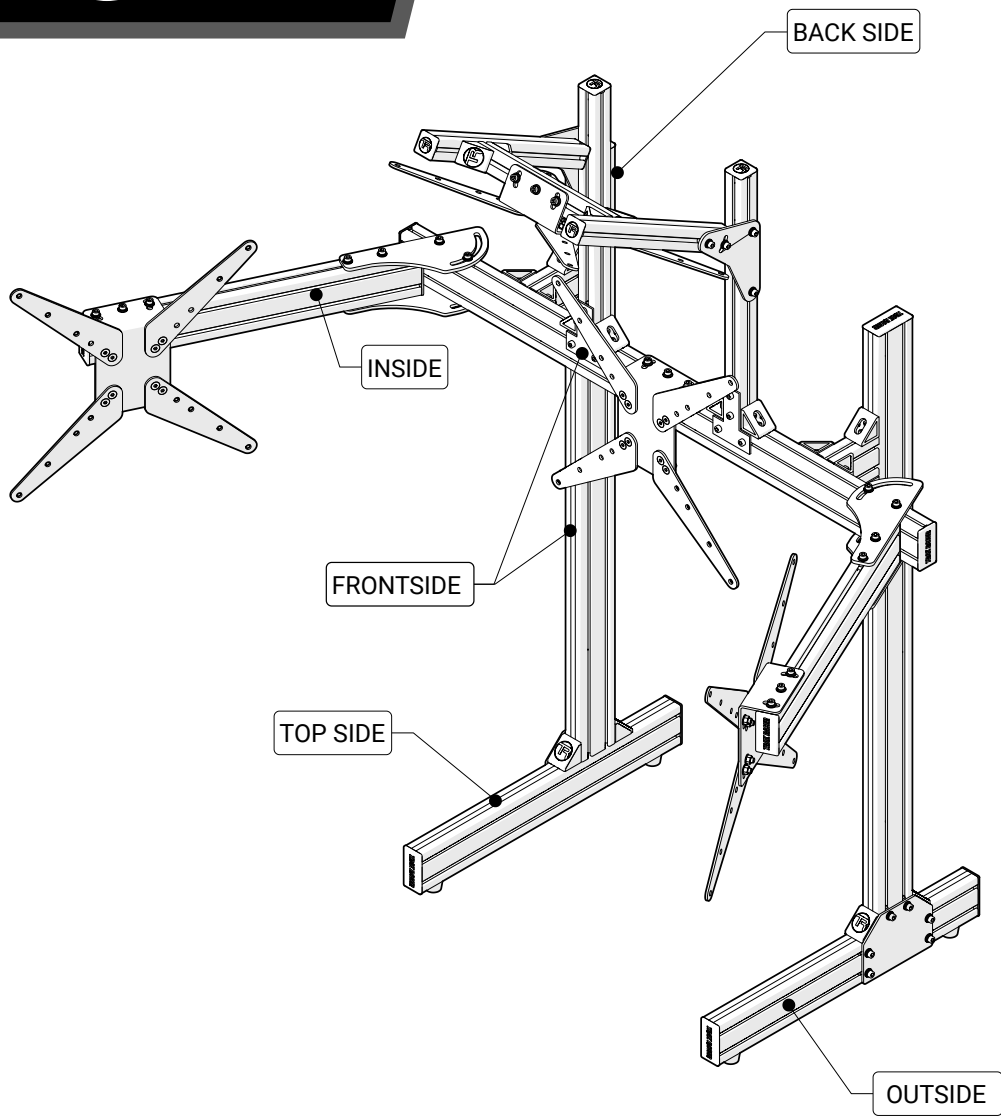

INSTALLATION ORDER FOR SCREWS & WASHERS

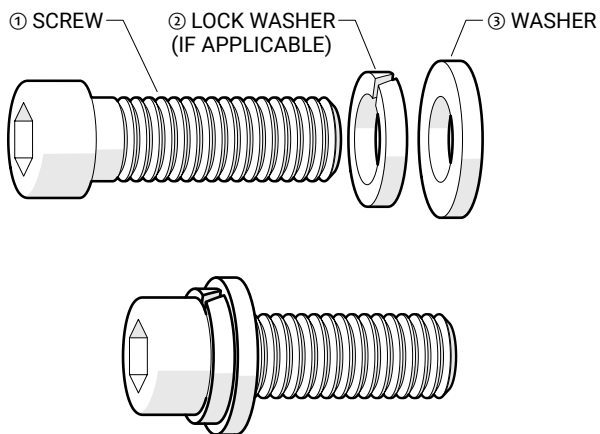

HOW TO MEASURE SCREWS

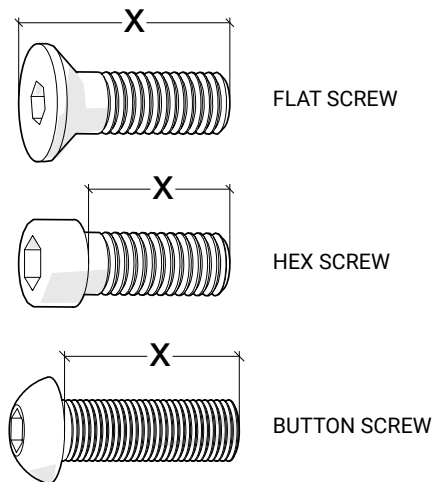

NOTE

The handle screws (SL-M8-20 & SL-M8-25) are ratcheted to allow for tightening and loosening when space for rotation is limited. Simply pull the handle out and turn handle into position and push handle back in to engage thread.

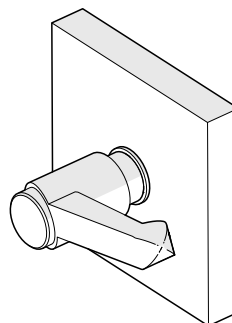
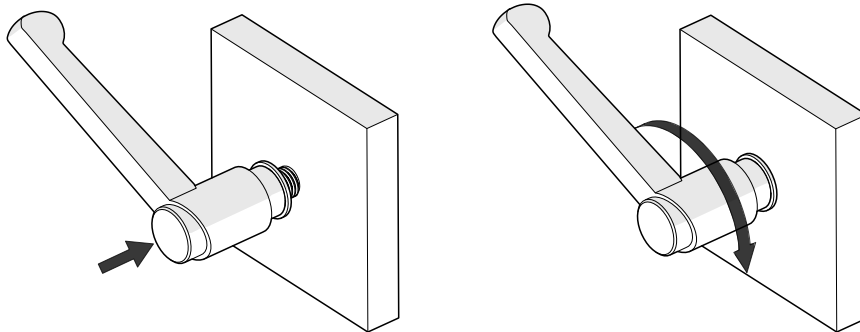
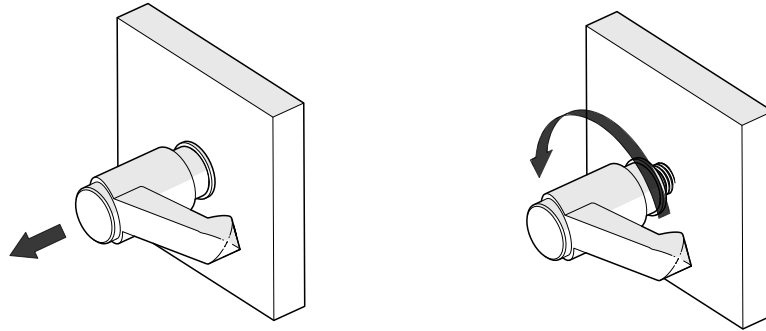
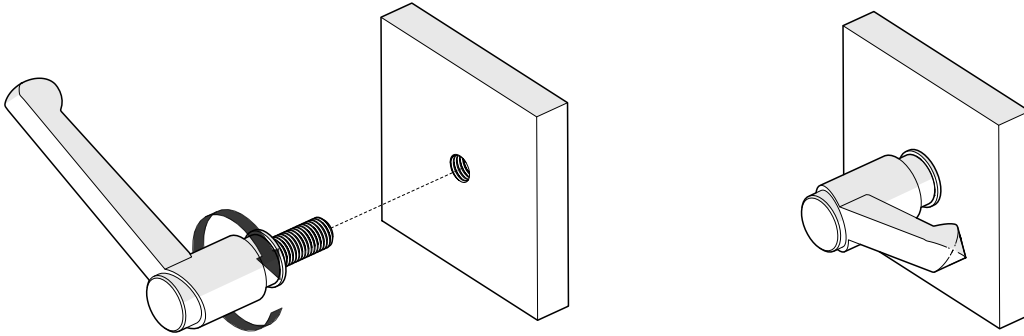

NOTE

NS-M8 & NS-M6

It is strongly advised that spring T-Nuts are inserted by sliding from the ends of profiles. Please take careful note of each step of all T-nuts as some are to be installed in anticipation of future steps.

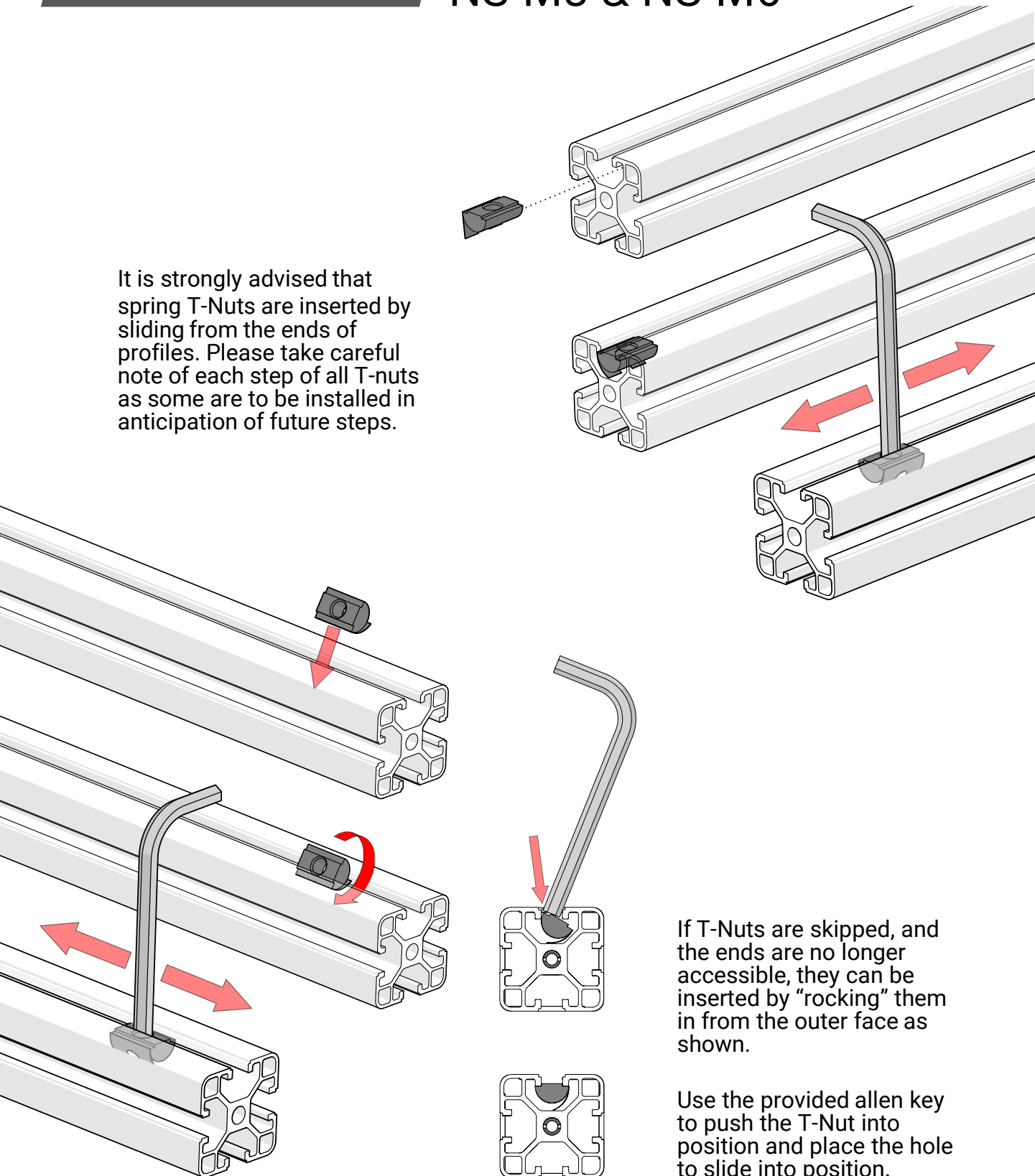

If T-Nuts are skipped, and the ends are no longer accessible, they can be inserted by "rocking" them in from the outer face as shown.

Use the provided allen key to push the T-Nut into position and place the hole to slide into position.

NOTE

BC-40

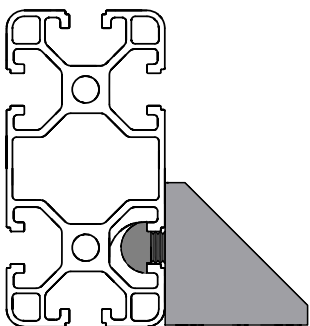
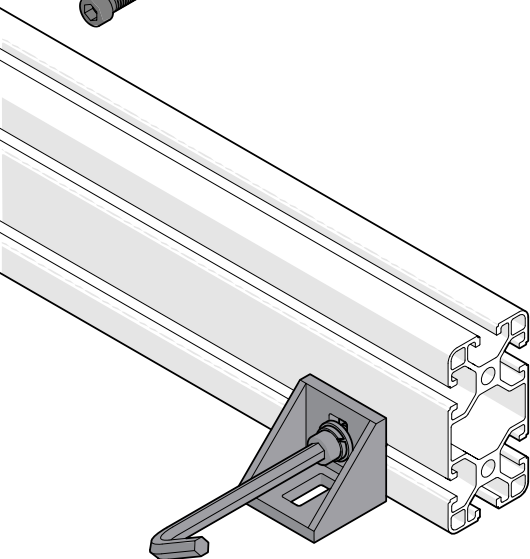
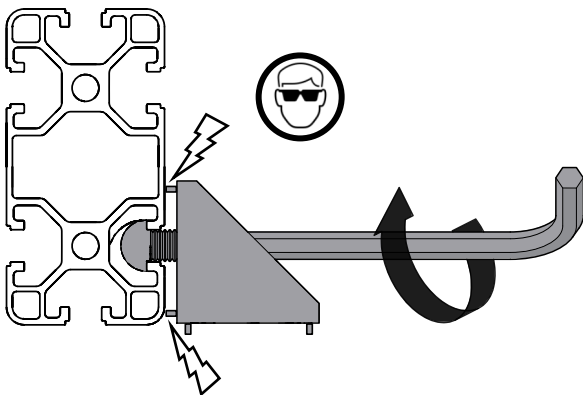
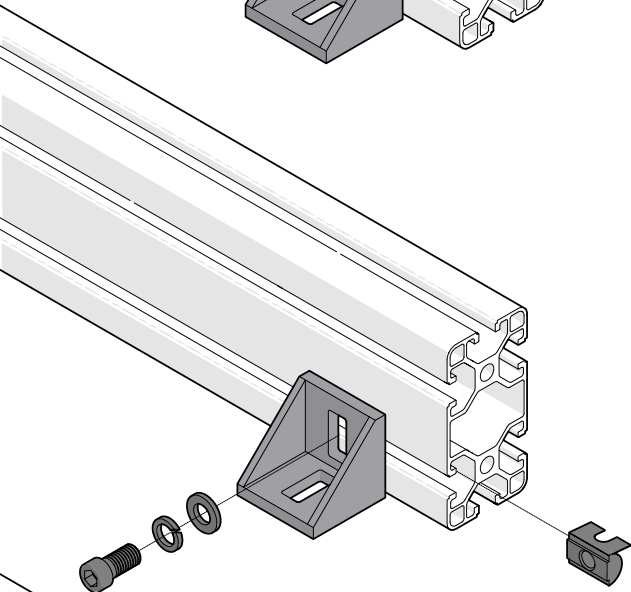
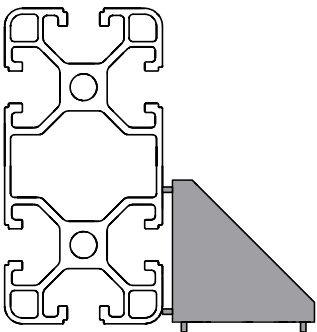
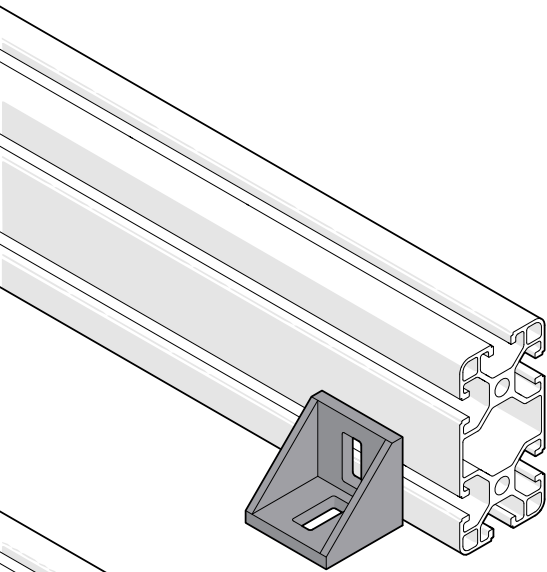

Floor Single Monitor Stand with VESA Mount

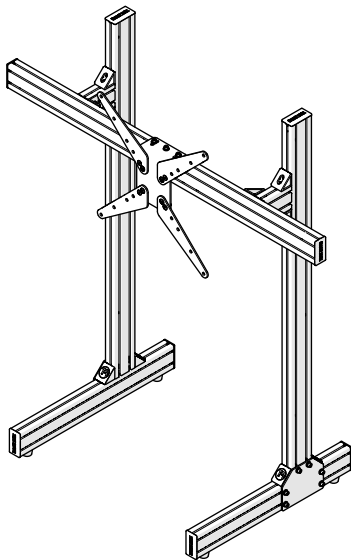
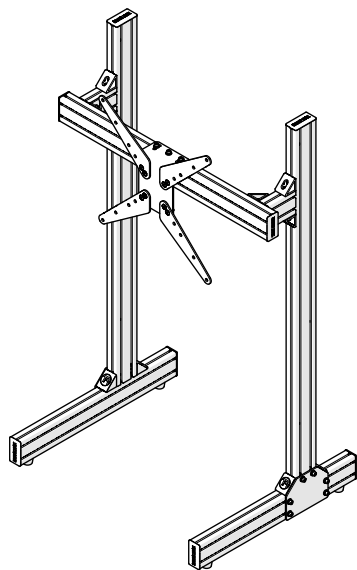

MS-SML-FM (800mm Crossbar)

| Part # | Description | QTY | Check |
|-------------------------------|--|-----|-------|
| BOX #: TR80-FMMS5-BLK | | | |
| PS-600-R | Profile strip, 600mm Red | 2 | |
| PS-1200-R | Profile strip, 1200mm Red | 2 | |
| BC-40 | Bracket, Corner with Cap, 40x40 | 4 | |
| BA-80-BLK | Bracket, Anodized corner, 40x80, Black | 4 | |
| BA-40-BLK | Bracket, Anodized corner, 40x40, Black | 4 | |
| EC-80 | End Cap, 40x80 | 6 | |
| BP-80-V | Bracket (Plate), 80, Vertical | 2 | |
| NS-M8 | T-Nut (Spring), M8 | 44 | |
| AL-80-1200 | Aluminum Profile, 40x80x1200mm | 2 | |
| AL-80-600 | Aluminum Aluminum Profile, 40x80x600mm | 2 | |
| AL-80-105 | Aluminum Profile, 40x80x105mm | 2 | |
| SH-M8-16 | Screw (Hex), M8x16 | 24 | |
| SH-M8-20 | Screw (Hex), M8x20 | 20 | |
| WF-M8 | Washer (Flat), M8 | 20 | |
| WL-M8 | Washer (Lock), M8 | 20 | |
| OPTIONAL | | | |
| FR-01 | Feet, Rubber | 4 | |
| NS-M6 | T-Nut (Spring), M6 | 4 | |
| SH-M6-20 | Screw (Hex), M6x20 | 4 | |
| BOX #: TR80-TMSML3-BLK | | | |
| BA-80-BLK | Bracket, Anodized corner, 40x80, Black | 2 | |
| EC-80 | End Cap, 40x80 | 2 | |
| NF-M8 | Nut (Flange), M8 | 8 | |
| NS-M8 | T-Nut (Spring), M8 | 11 | |
| AL-80-800 | Aluminum Aluminum Profile, 40x80x800mm | 1 | |
| SF-M8-16 | Screw (Flat), M8x16 | 8 | |
| SH-M8-16 | Screw (Hex), M8x16 | 8 | |
| SH-M8-20 | Screw (Hex), M8x20 | 3 | |
| VM-02 | VESA new | 1 | |
| WF-M8 | Washer (Flat), M8 | 3 | |
| WL-M8 | Washer (Lock), M8 | 3 | |

MS-FM-SIN (1200mm Crossbar)

| Part # | Description | QTY | Check |
|-------------------------------|--|-----|-------|
| BOX #: TR80-FMMS5-BLK | | | |
| PS-600-R | Profile strip, 600mm Red | 2 | |
| PS-1200-R | Profile strip, 1200mm Red | 2 | |
| BC-40 | Bracket, Corner with Cap, 40x40 | 4 | |
| BA-80-BLK | Bracket, Anodized corner, 40x80, Black | 4 | |
| BA-40-BLK | Bracket, Anodized corner, 40x40, Black | 4 | |
| EC-80 | End Cap, 40x80 | 6 | |
| BP-80-V | Bracket (Plate), 80, Vertical | 2 | |
| NS-M8 | T-Nut (Spring), M8 | 44 | |
| AL-80-1200 | Aluminum Profile, 40x80x1200mm | 2 | |
| AL-80-600 | Aluminum Aluminum Profile, 40x80x600mm | 2 | |
| AL-80-105 | Aluminum Profile, 40x80x105mm | 2 | |
| SH-M8-16 | Screw (Hex), M8x16 | 24 | |
| SH-M8-20 | Screw (Hex), M8x20 | 20 | |
| WF-M8 | Washer (Flat), M8 | 20 | |
| WL-M8 | Washer (Lock), M8 | 20 | |
| OPTIONAL | | | |
| FR-01 | Feet, Rubber | 4 | |
| NS-M6 | T-Nut (Spring), M6 | 4 | |
| SH-M6-20 | Screw (Hex), M6x20 | 4 | |
| BOX #: TR80-TMSIN4-BLK | | | |
| BA-80-BLK | Bracket, Anodized corner, 40x80, Black | 2 | |
| BA-40-BLK | Bracket, Anodized corner, 40x40, Black | 4 | |
| EC-80 | End Cap, 40x80 | 2 | |
| NF-M8 | Nut (Flange), M8 | 8 | |
| NS-M8 | T-Nut (Spring), M8 | 19 | |
| AL-80-1200 | Aluminum Profile, 40x80x1200mm | 1 | |
| SF-M8-16 | Screw (Flat), M8x16 | 8 | |
| SH-M8-16 | Screw (Hex), M8x16 | 16 | |
| SH-M8-20 | Screw (Hex), M8x20 | 3 | |
| VM-02 | VESA new | 1 | |
| WF-M8 | Washer (Flat), M8 | 3 | |
| WL-M8 | Washer (Lock), M8 | 3 | |

* NOTE: Extra hardware may be included as spare parts

MS-SML-FM
MS-FM-SIN

1

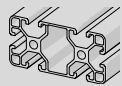

AL-80-600 x2

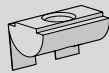

NS-M8 x8

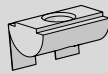

NS-M6 x4

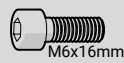

SH-M6-16 x4



FR-01 x4

NOTE: Rubber feet and hardware are optional.

a

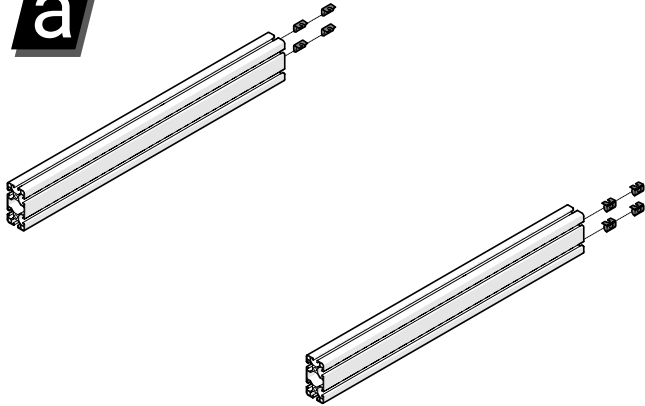

b

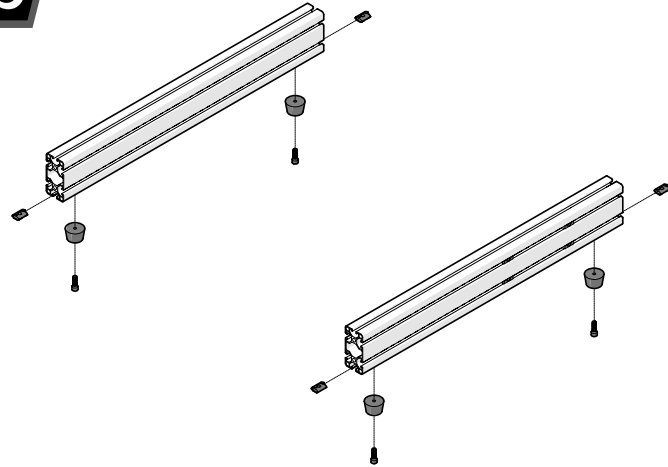

Insert 4pcs of NS-M8 into
OUTSIDE of each of
AL-80-600 (for STEP 2b)



2

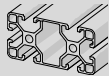

AL-80-1200 x2

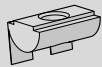

NS-M8 x8



SH-M8-20 x12



WL-M8 x12



WF-M8 x12



BP-80-V x2

Insert 1pcs of NS-M8 into
FRONT & BACK SIDE of each
of AL-80-1200 (for STEP 3)



a

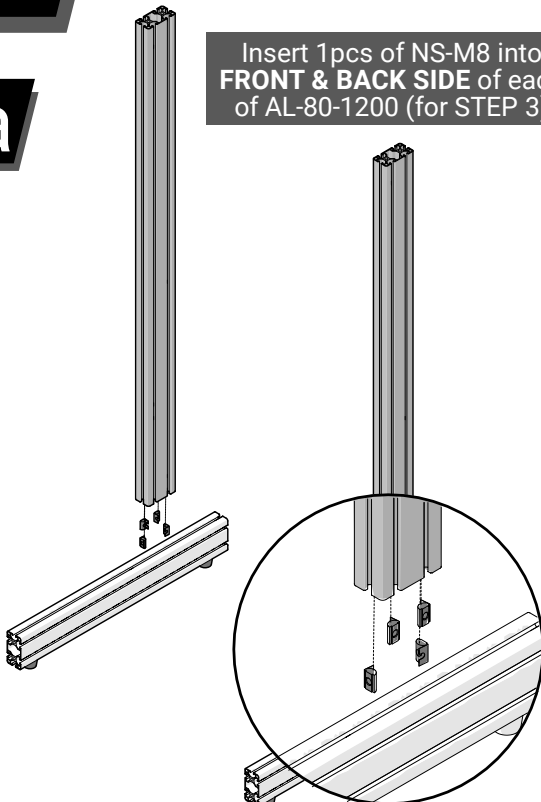

b

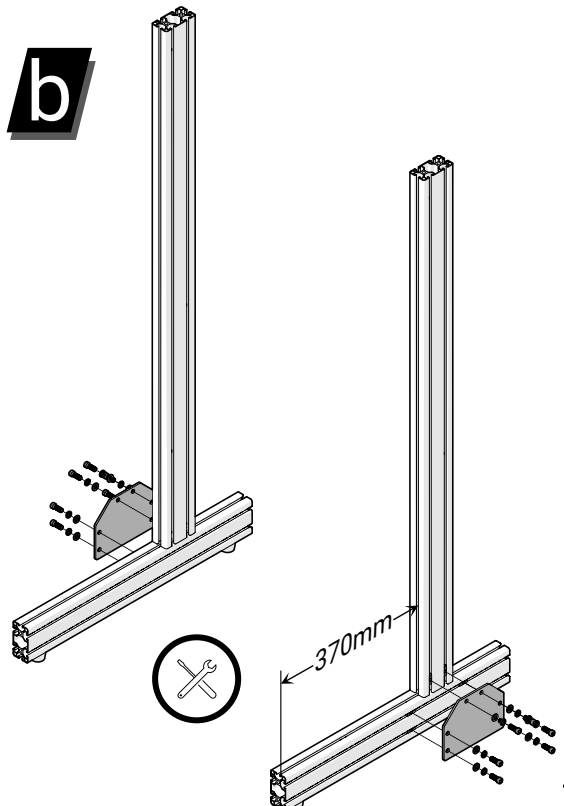

3

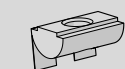

NS-M8 x12



SH-M8-20 x8



WL-M8 x8



WF-M8 x8



BC-40 x4

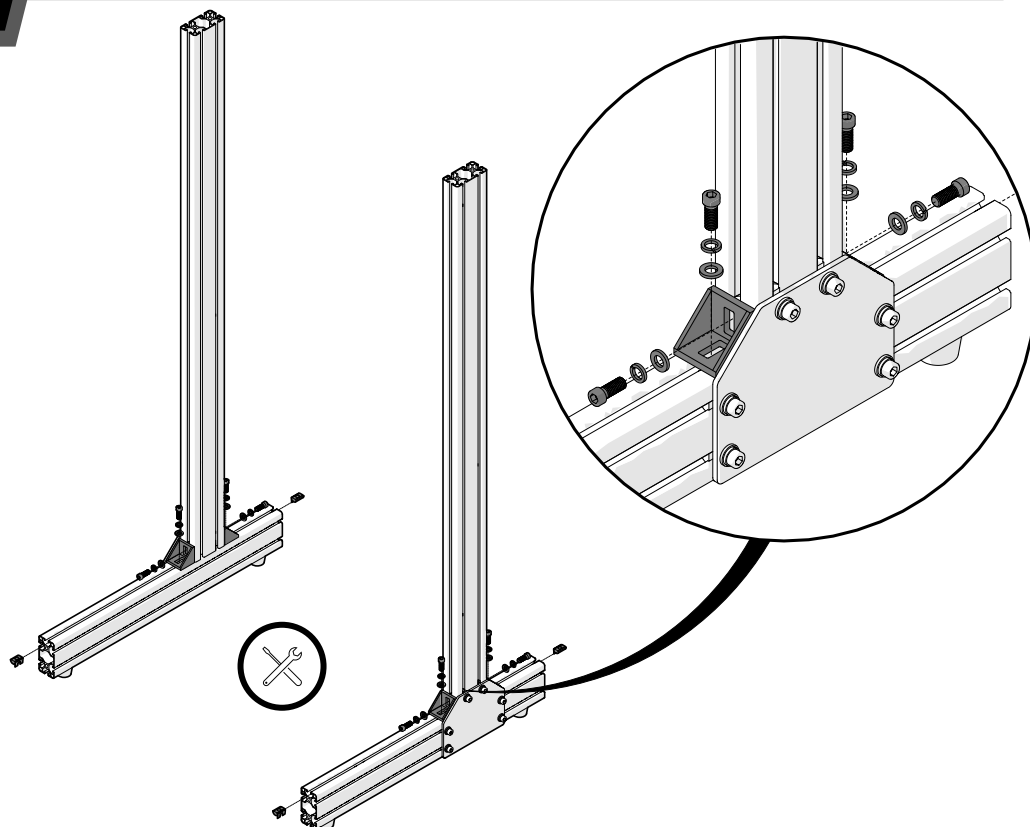

4

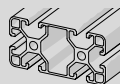

AL-80-105 x2

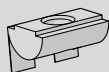

NS-M8 x8

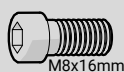

SH-M8-16 x8



BA-40-BLK x4

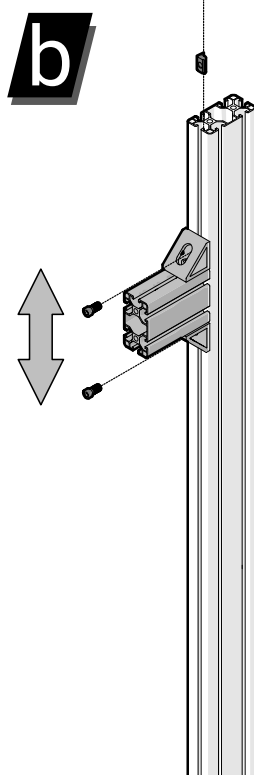
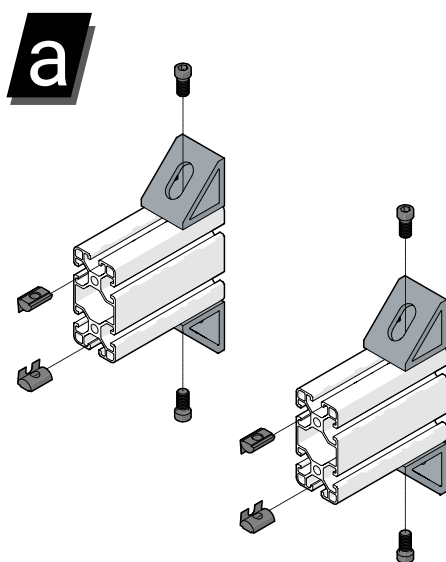

Roughly adjust according to desired height and/or monitor size

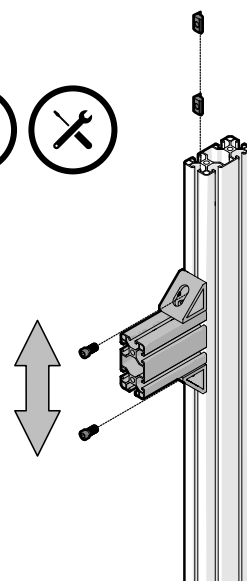
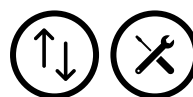

5_a

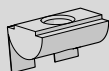

NS-M8 x4

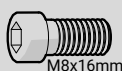

SH-M8-16 x4



BA-80-BLK x2

TR80-TMSML3

NOTE: 800mm long cross bar. If using 1200mm cross bar, see STEP 5b.

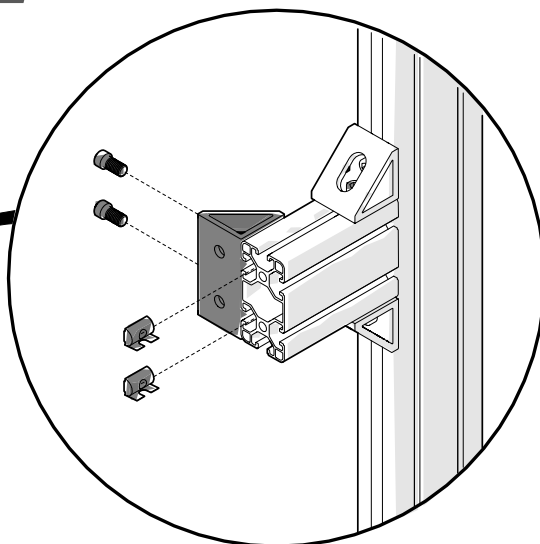
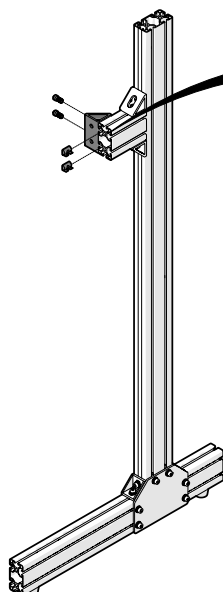
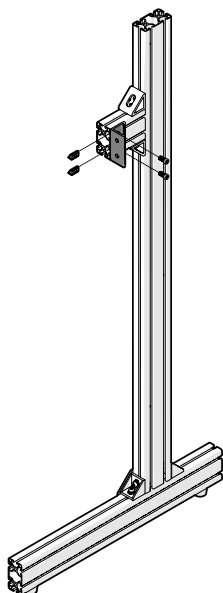

Ensure corner brackets are facing inward



5_b

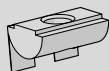

NS-M8 x8

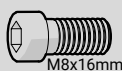

SH-M8-16 x8



BA-80-BLK x4

TR80-TMSIN4

NOTE: 1200mm long cross bar. If using 800mm cross bar, see STEP 5a.

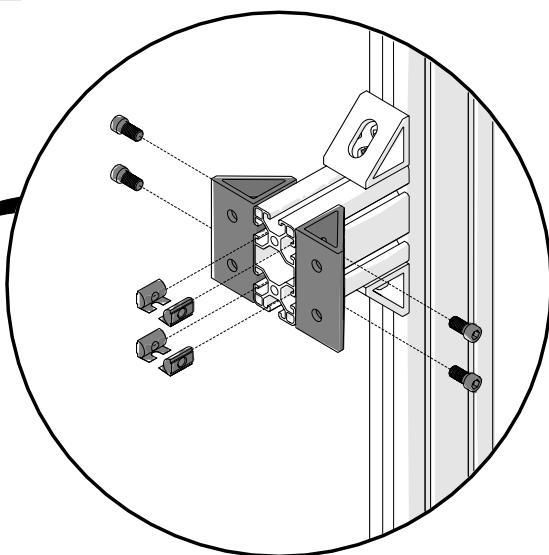
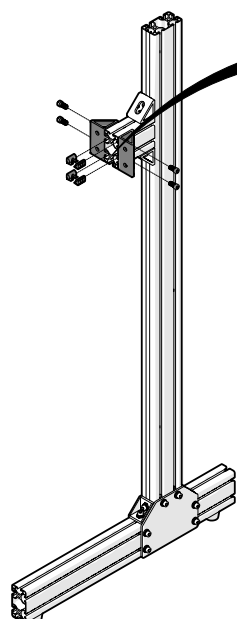
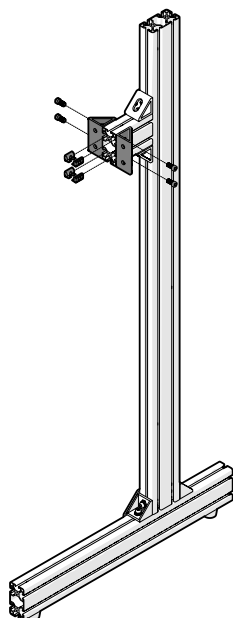

6_a

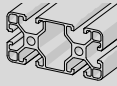

AL-80-800 x1

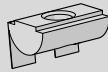

NS-M8 x4



M8x16mm

SH-M8-16 x4

NOTE: 800mm long cross bar

TR80-TMSML3

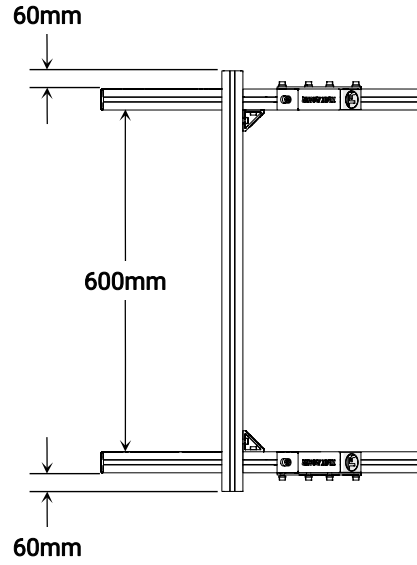
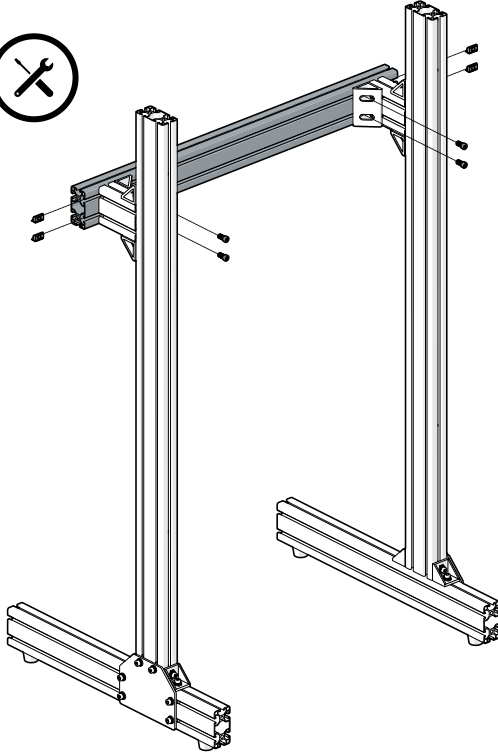

6_b

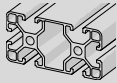

AL-80-1200 x1

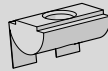

NS-M8 x8



M8x16mm

SH-M8-16 x8

NOTE: 1200mm long cross bar

TR80-TMSIN4

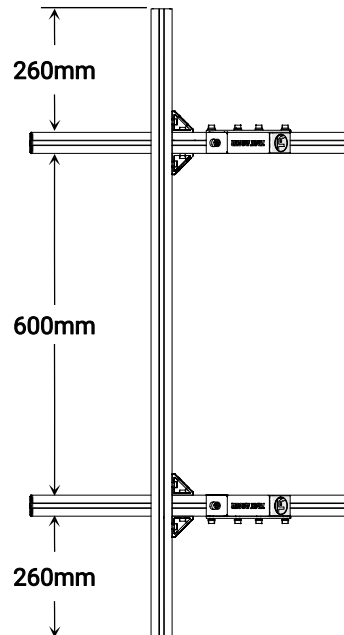
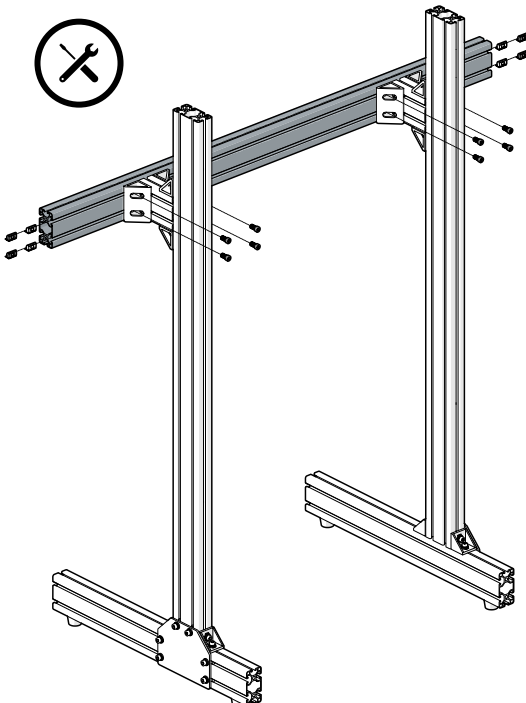

7

- VM-02 x1
- NS-M8 x8
- SH-M8-20 x3
- WL-M8 x3
- WF-M8 x3

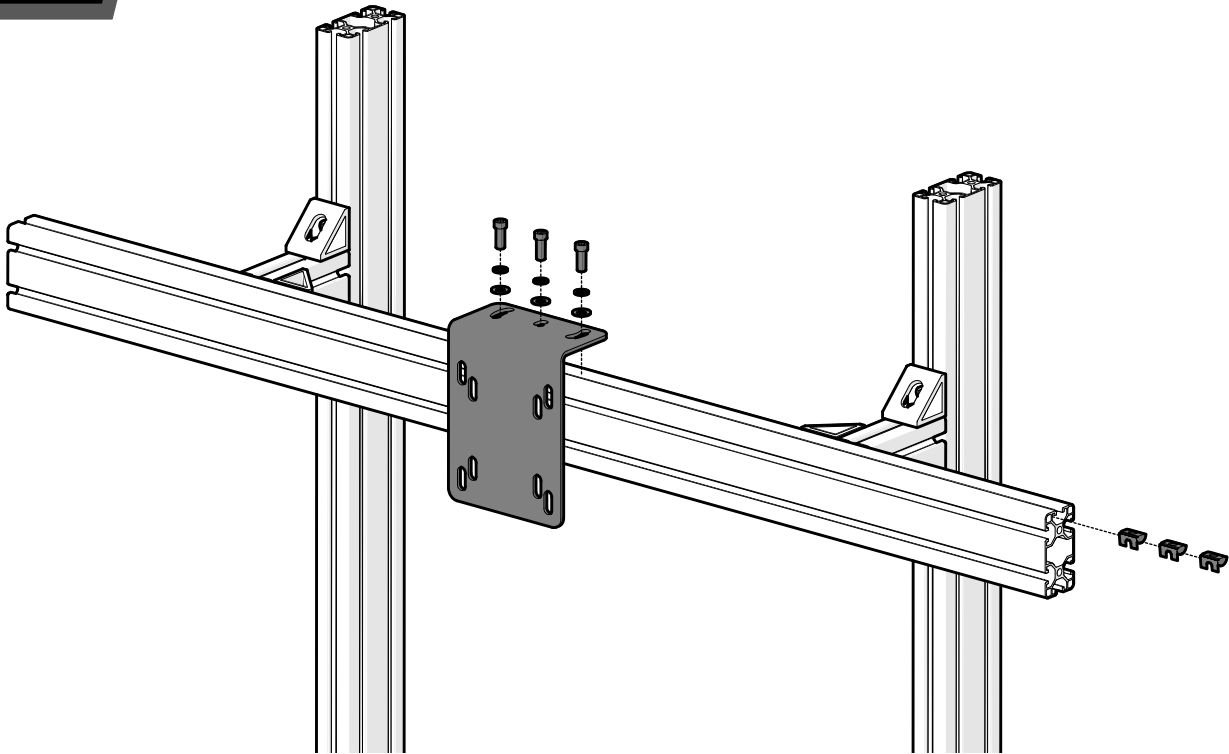

8

- VM-02-A x2
- VM-02-B x2
- SF-M8-16 x8
- NF-M8 x8

NOTE: Optional for larger monitors.

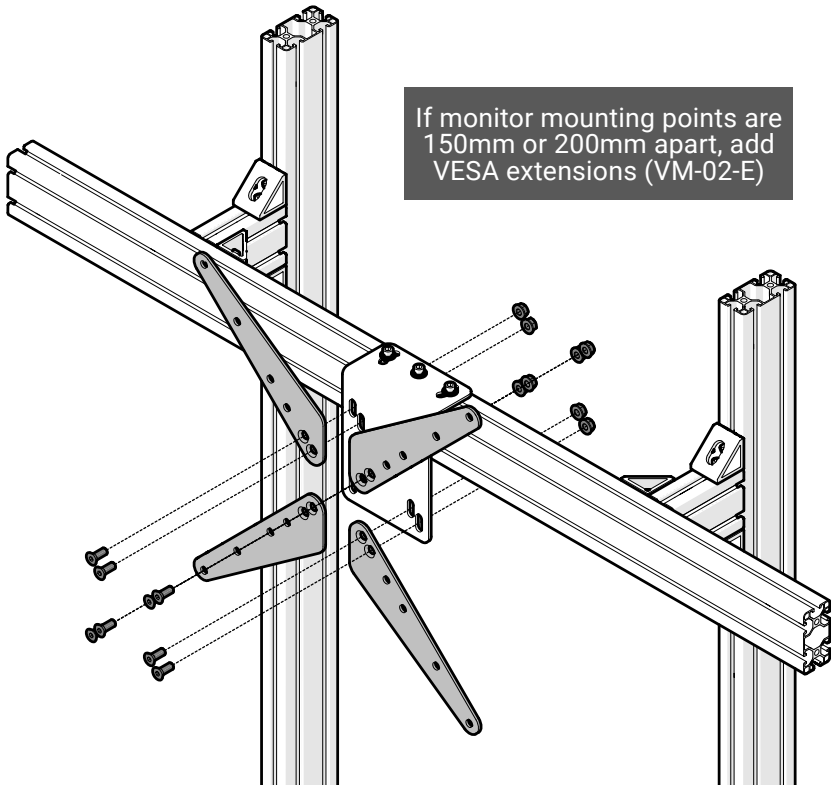

If monitor mounting points are 150mm or 200mm apart, add VESA extensions (VM-02-E)

9



EC-80 x8



BC-40 x4

NOTE: If installing Arms for triple monitors, skip this step until assembly of all other components is complete.

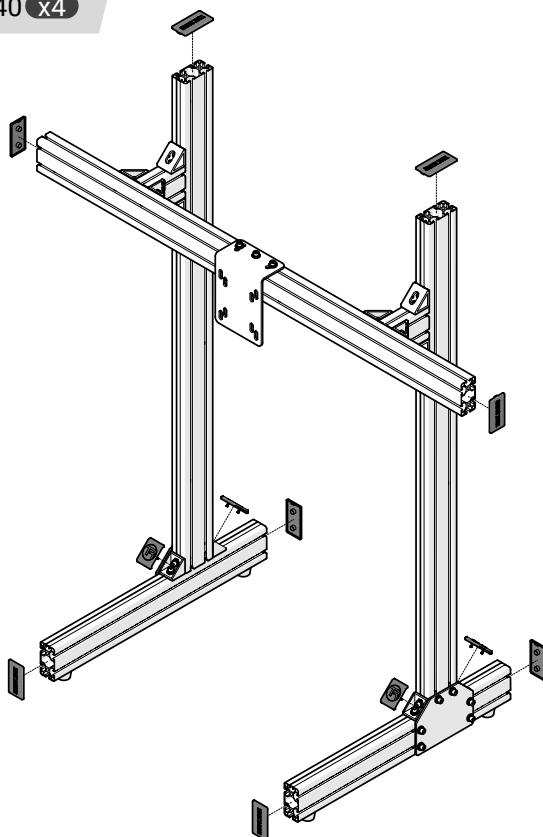

10



PS-600-R x2

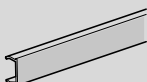

PS-1200-R x2

NOTE: Tape measure and scissors not supplied

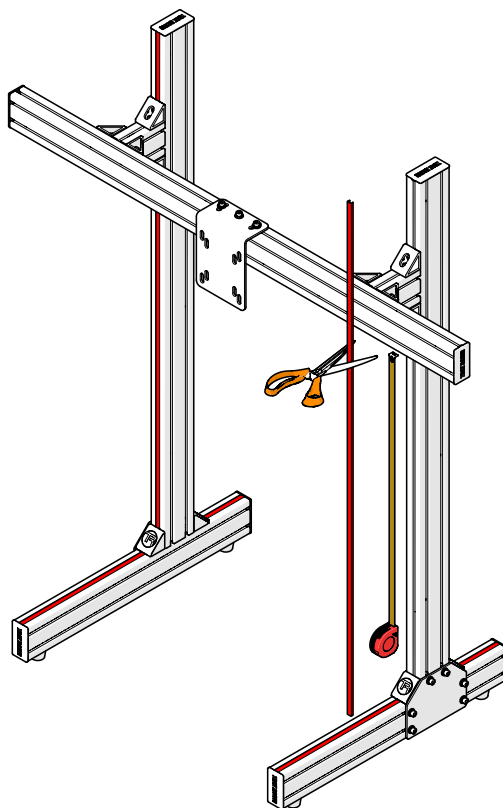

11



IMPORTANT: If your monitor screws are under 8mm (M8), you will need to use washers (not supplied)

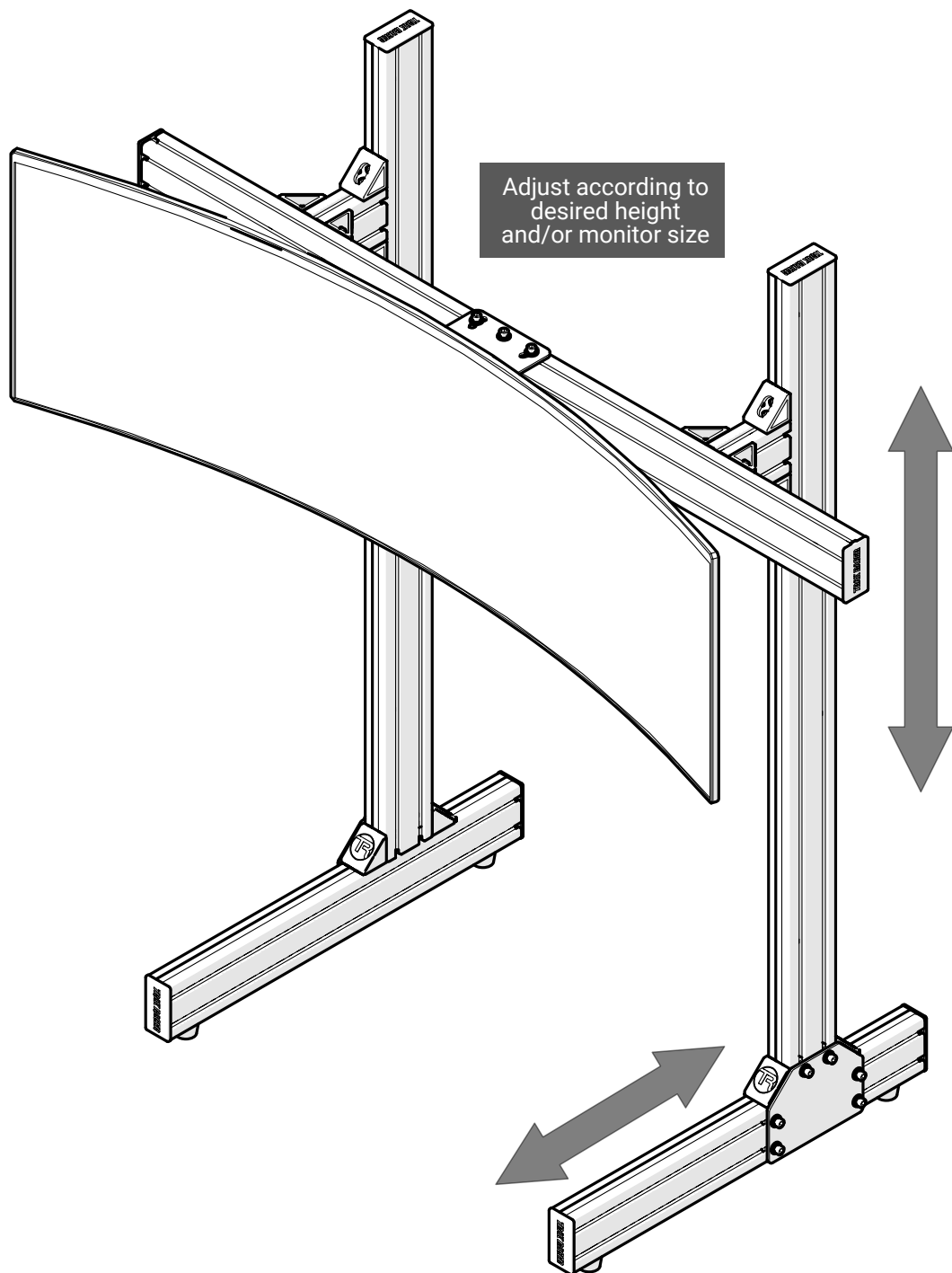

Arms for Triple Monitors with VESA Mounts

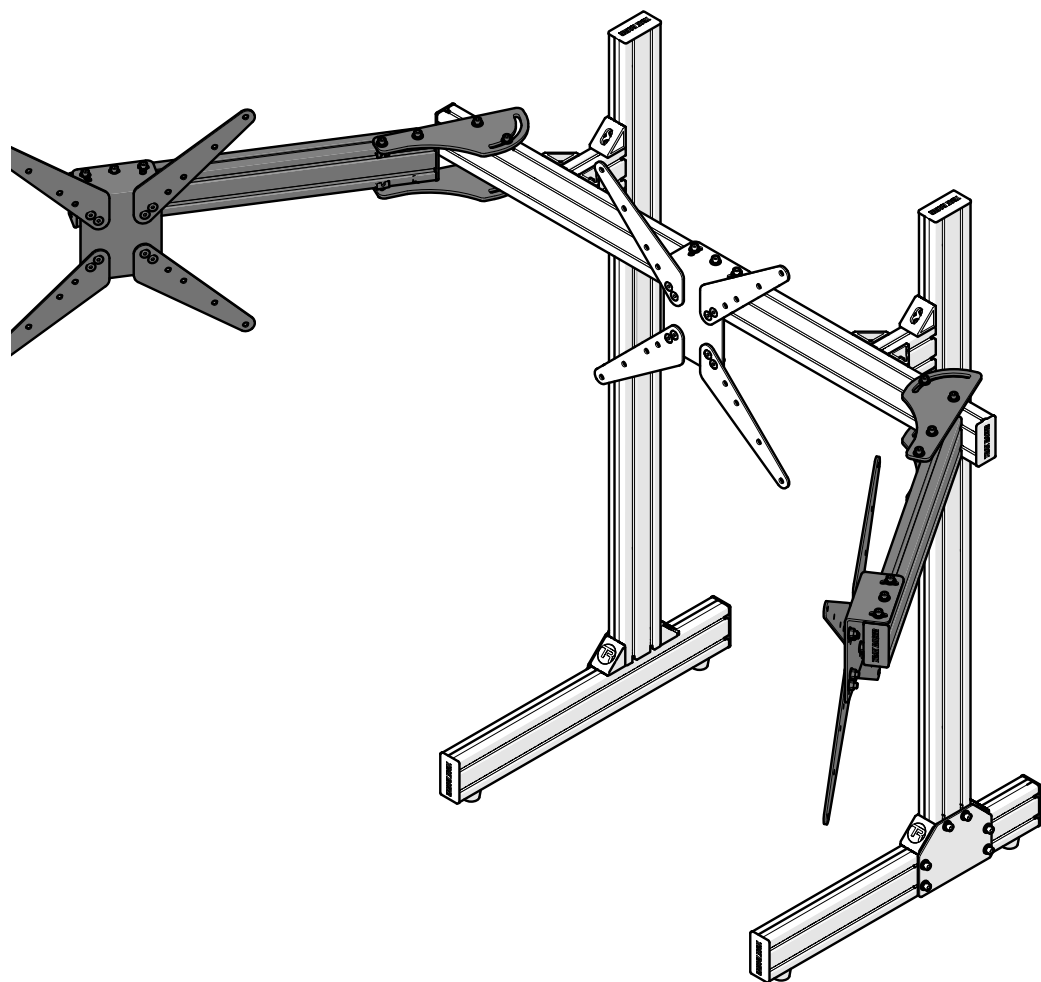

| Part # | Description | QTY | Check |
|-----------|--|-----|-------|
| BM-TA | Bracket (Monitor), Triple Adjustable | 4 | |
| EC-80 | End Cap, 40x80 | 4 | |
| NF-M8 | Nut (Flange), M8 | 16 | |
| NS-M8 | T-Nut (Spring), M8 | 22 | |
| AL-80-580 | Aluminum Aluminum Profile, 40x80x580mm | 2 | |
| SH-M8-20 | Screw (Hex), M8x20 | 22 | |
| SF-M8-16 | Screw (Flat), M8x16 | 16 | |
| VM-02 | VESA new | 2 | |
| WF-M8 | Washer (Flat), M8 | 22 | |
| WL-M8 | Washer (Lock), M8 | 22 | |

* **NOTE:** Extra hardware may be included as spare parts

TR80-TMARM4-BLK

12



BM-TA x8

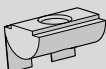

NS-M8 x8



M8x20mm

SH-M8-20 x8



WL-M8 x8



WF-M8 x8

NOTE: End caps may need to be removed to insert t-nuts.

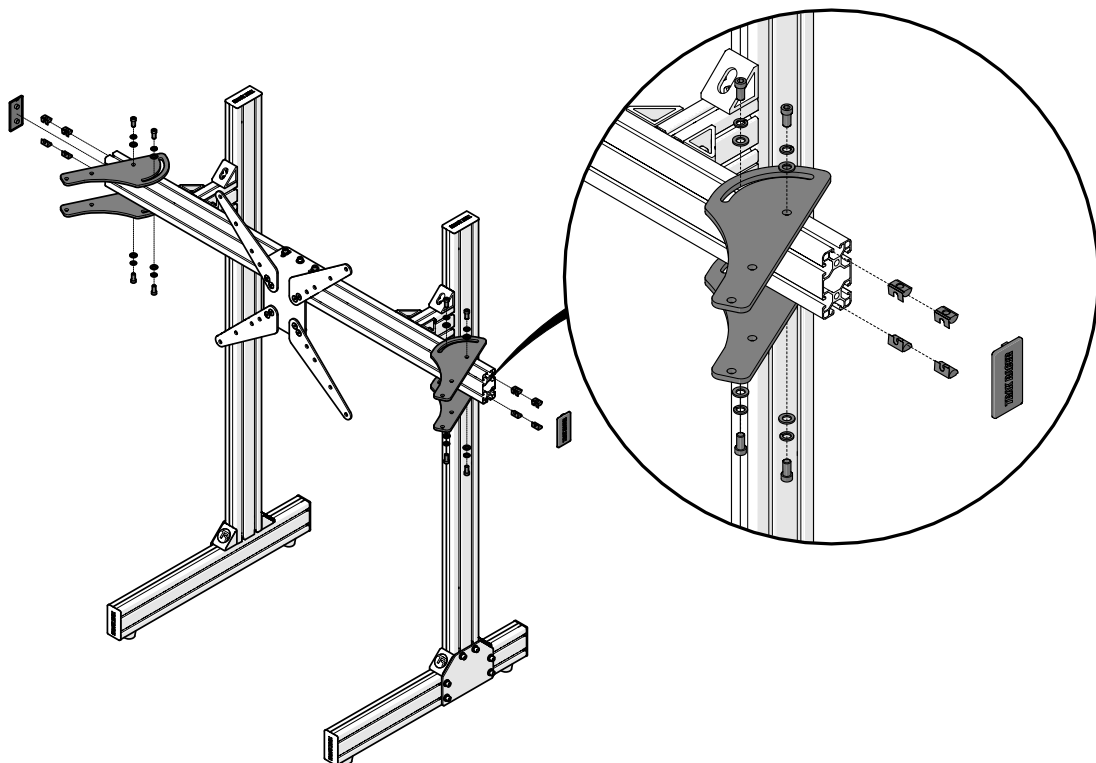

13

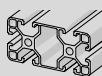

AL-80-580 x2



NS-M8 x8



M8x20mm

SH-M8-20 x8



WL-M8 x8



WF-M8 x8



EC-80 x2

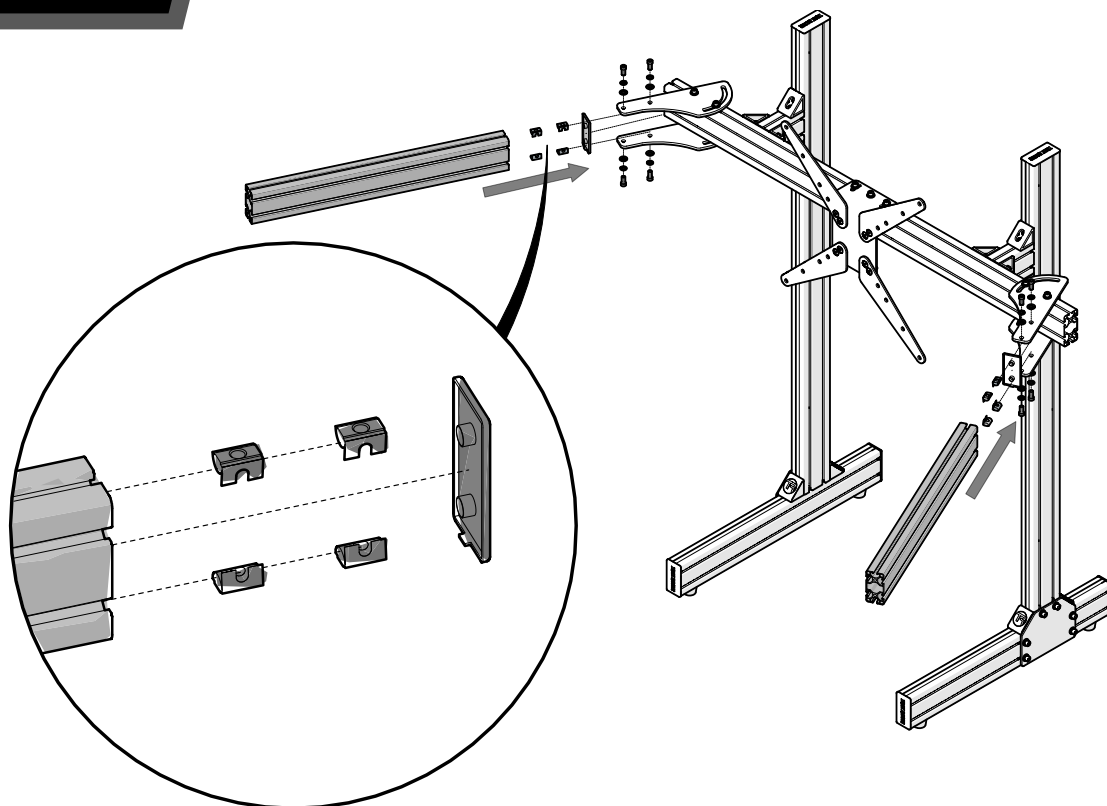

14



VM-02 x2

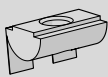

NS-M8 x6

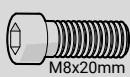

SH-M8-20 x6



WL-M8 x6



WF-M8 x6

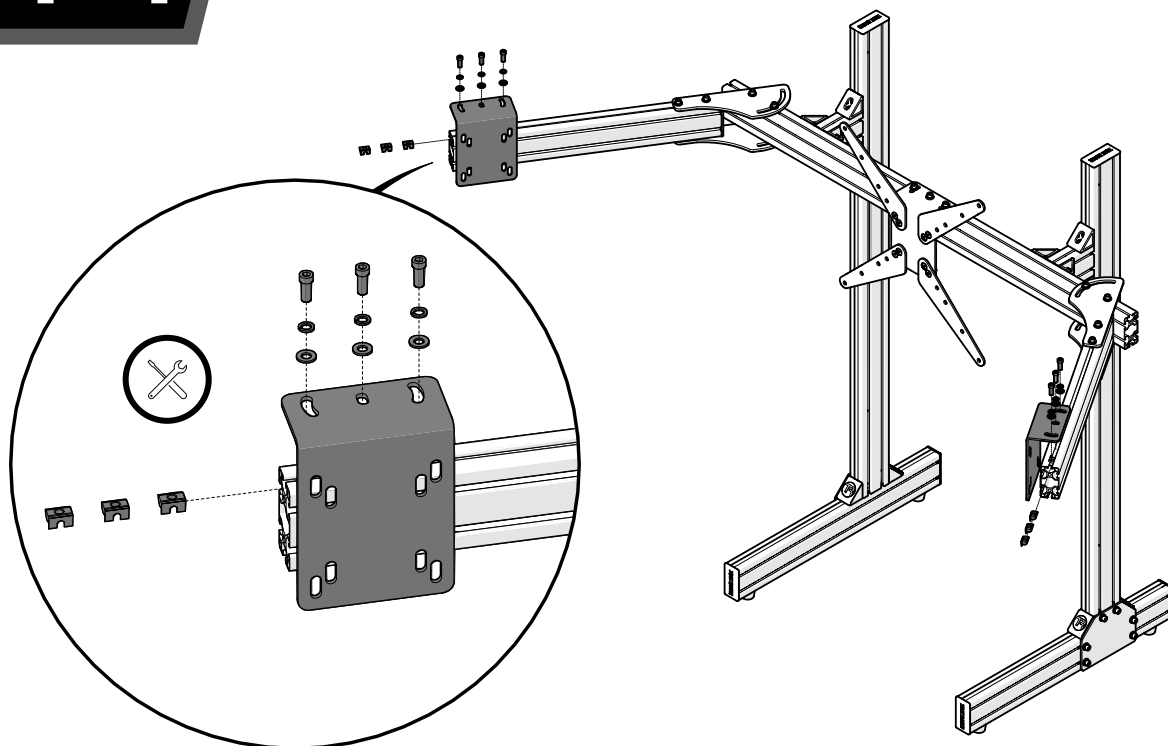

15

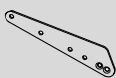

VM-02-A x4

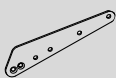

VM-02-B x4

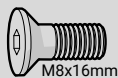

SF-M8-16 x16



NF-M8 x16

NOTE: Optional for larger monitors.

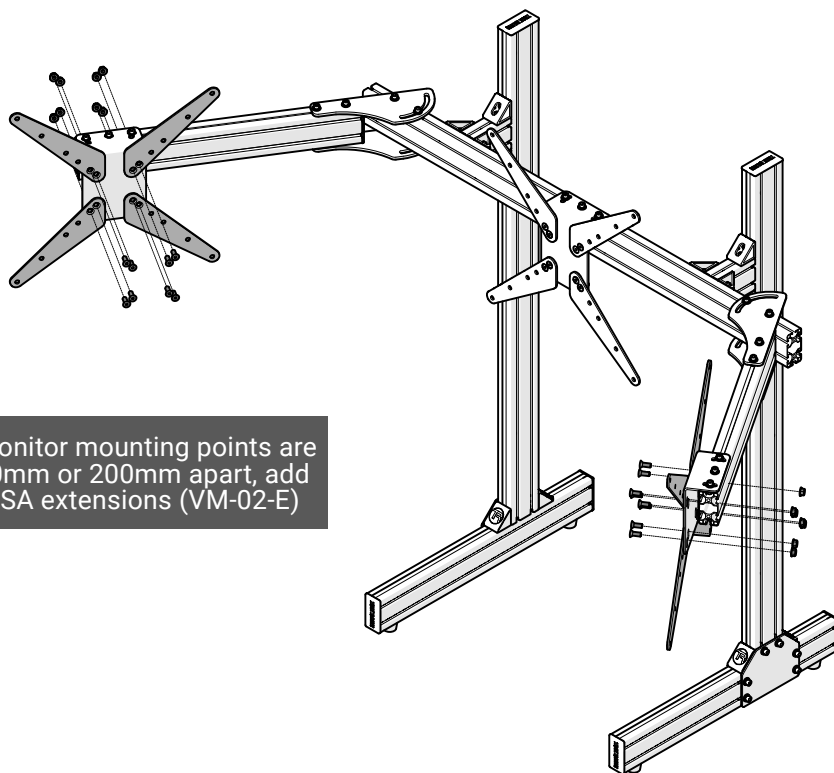

If monitor mounting points are 150mm or 200mm apart, add VESA extensions (VM-02-E)

16



EC-80 x4

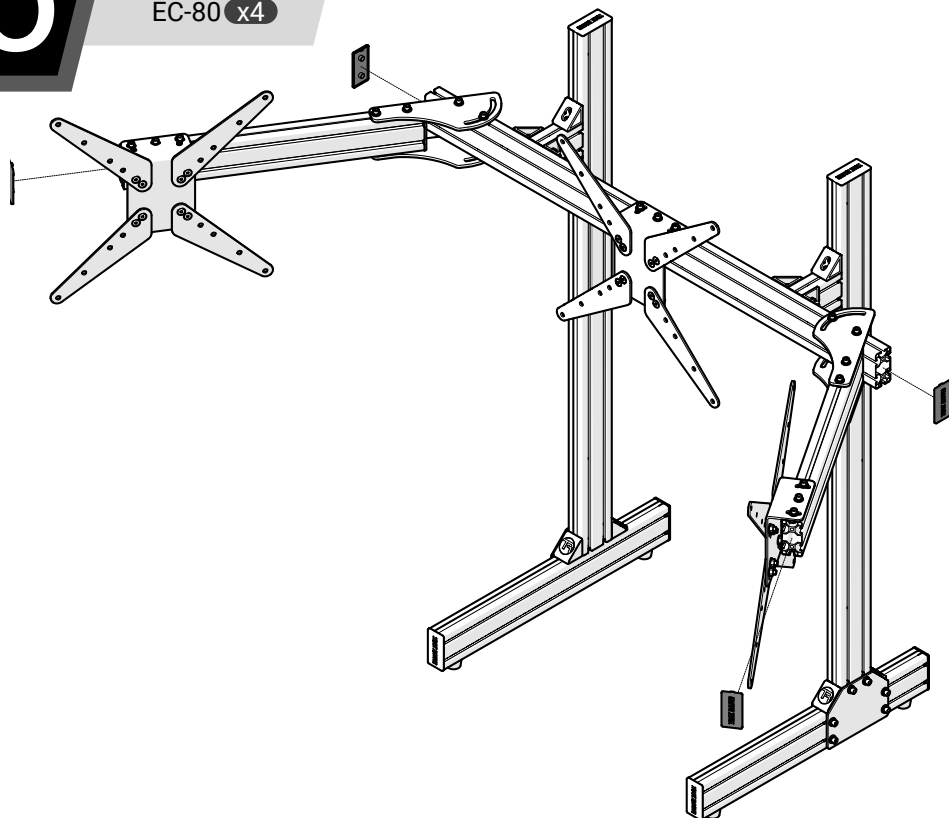

17



IMPORTANT: If your monitor screws are under 8mm (M8), you will need to use washers (not supplied)

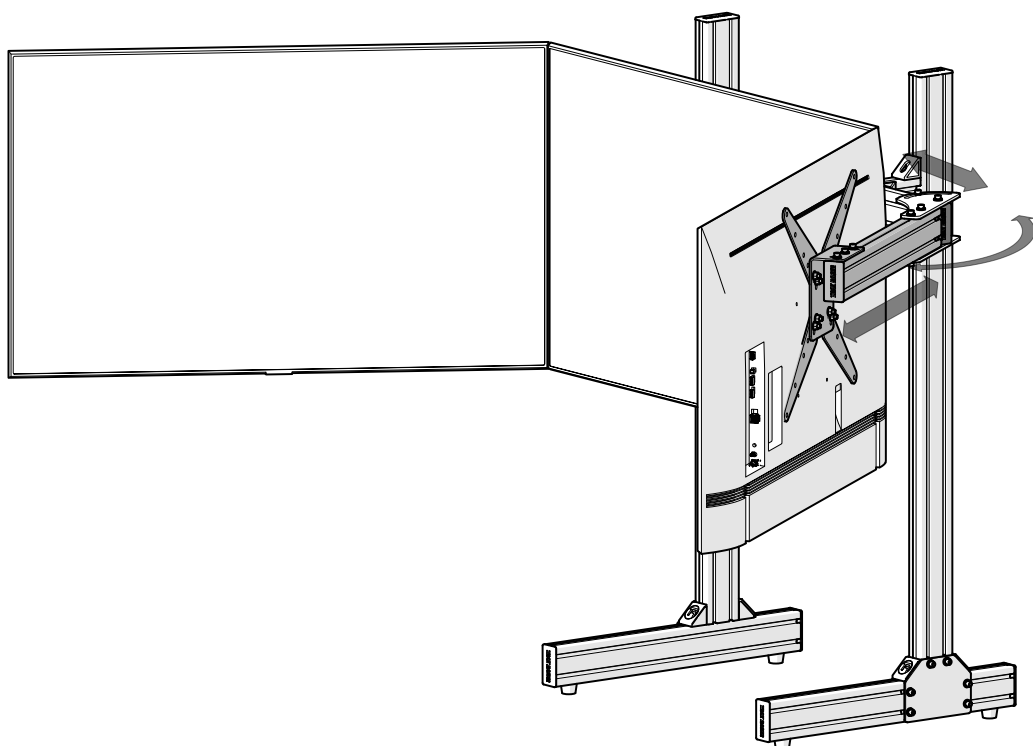

Overhead Monitor Stand with VESA Mount

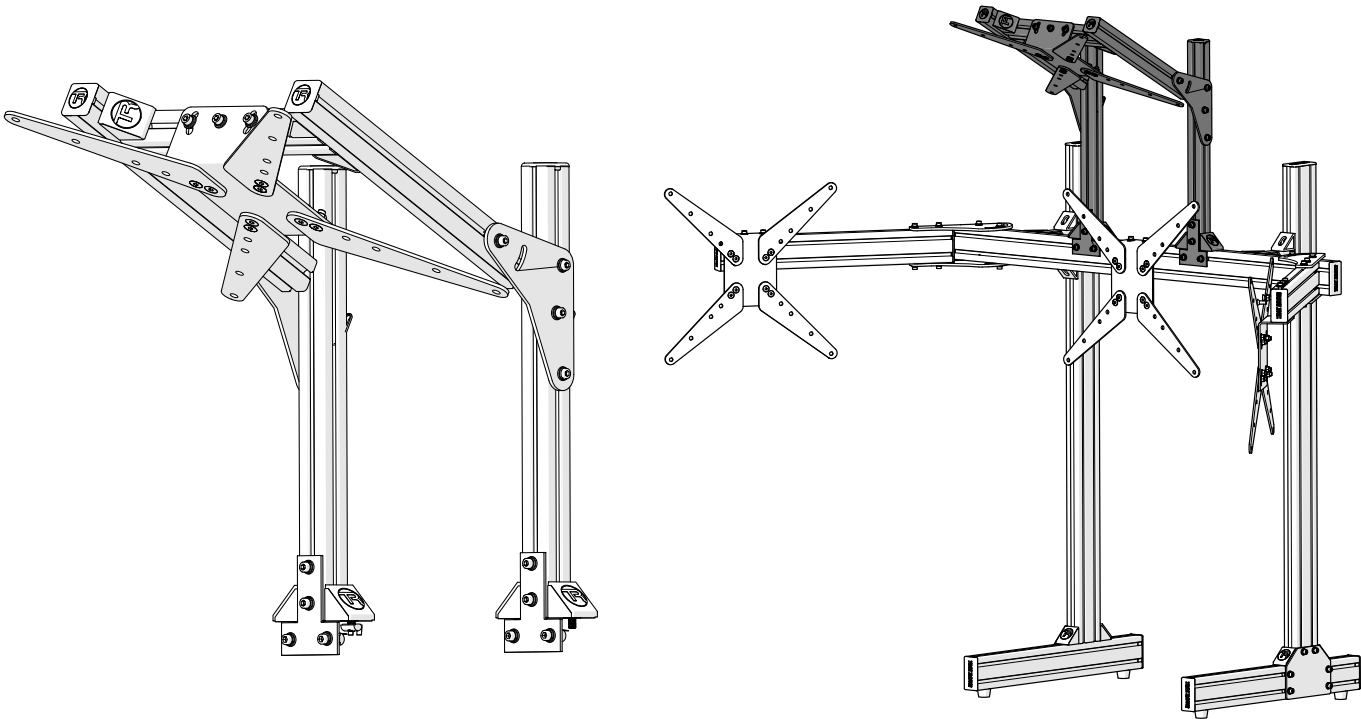

| Part # | Description | QTY | Check |
|-----------|------------------------------------|-----|-------|
| BM-QA | Bracket (Monitor), Quad Adjustable | 2 | |
| BC-40 | Bracket, Corner with Cap, 40x40 | 8 | |
| EC-40 | End Cap, 40x40 | 6 | |
| NF-M8 | Nut (Flange), M8 | 8 | |
| NS-M8 | T-Nut (Spring), M8 | 35 | |
| AL-40-500 | Aluminum Profile, 40x40x500mm | 2 | |
| AL-40-400 | Aluminum Profile, 40x40x400mm | 2 | |
| AL-40-300 | Aluminum Profile, 40x40x300mm | 1 | |
| SH-M8-16 | Screw (Hex), M8x16 | 8 | |
| SH-M8-20 | Screw (Hex), M8x20 | 27 | |
| SF-M8-16 | Screw (Flat), M8x16 | 8 | |
| BT-01 | Bracket, T Connector | 2 | |
| VM-02 | VESA new | 1 | |
| WF-M8 | Washer (Flat), M8 | 35 | |
| WL-M8 | Washer (Lock), M8 | 35 | |

* NOTE: Extra hardware may be included as spare parts

TR80-4M4-BLK



TRAK RACER

Published 2023-09-06

18_a

MS-FM-SIN-TR
MS-CM-SIN-TR

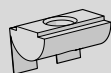

NS-M8 x4

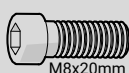

M8x20mm

SH-M8-20 x4



WL-M8 x4



WF-M8 x4



BC-40 x4

NOTE: Shown with TRIPLE monitor stand.

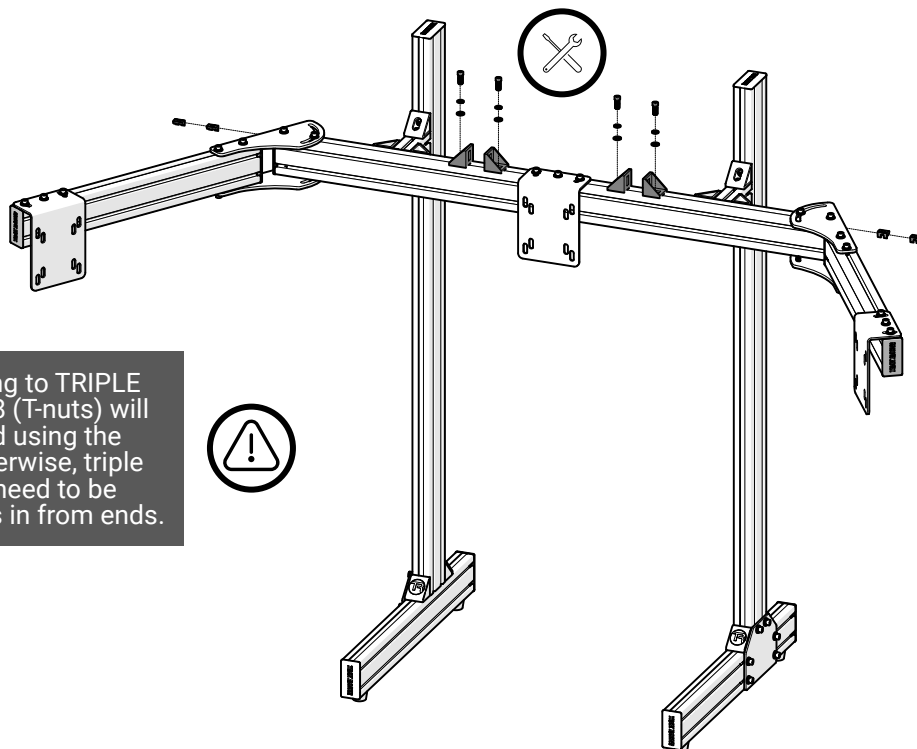

NOTE: When installing to TRIPLE monitor stand, NS-M8 (T-nuts) will need to be installed using the rocking method. Otherwise, triple monitor arms will need to be removed to slide t-nuts in from ends.

18_b

MS-FM-SIN-TR
MS-CM-SIN-TR

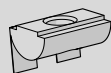

NS-M8 x4

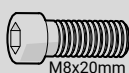

M8x20mm

SH-M8-20 x4



WL-M8 x4



WF-M8 x4



BC-40 x4

NOTE: Shown with SINGLE monitor stand.

NOTE: End caps may need to be removed to insert t-nuts.

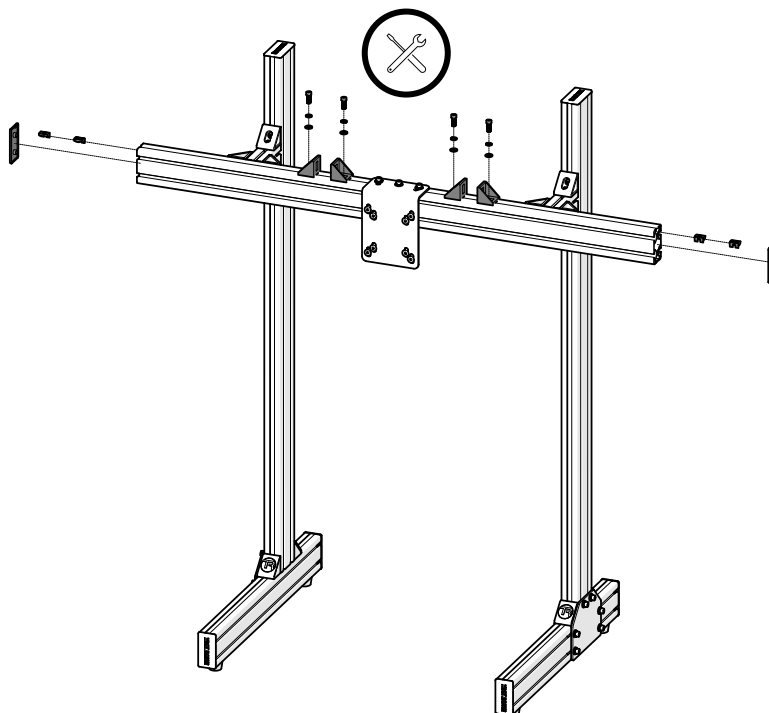

19



AL-40-500 x2

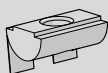

NS-M8 x4

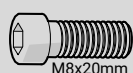

M8x20mm

SH-M8-20 x4



WL-M8 x4



WF-M8 x4

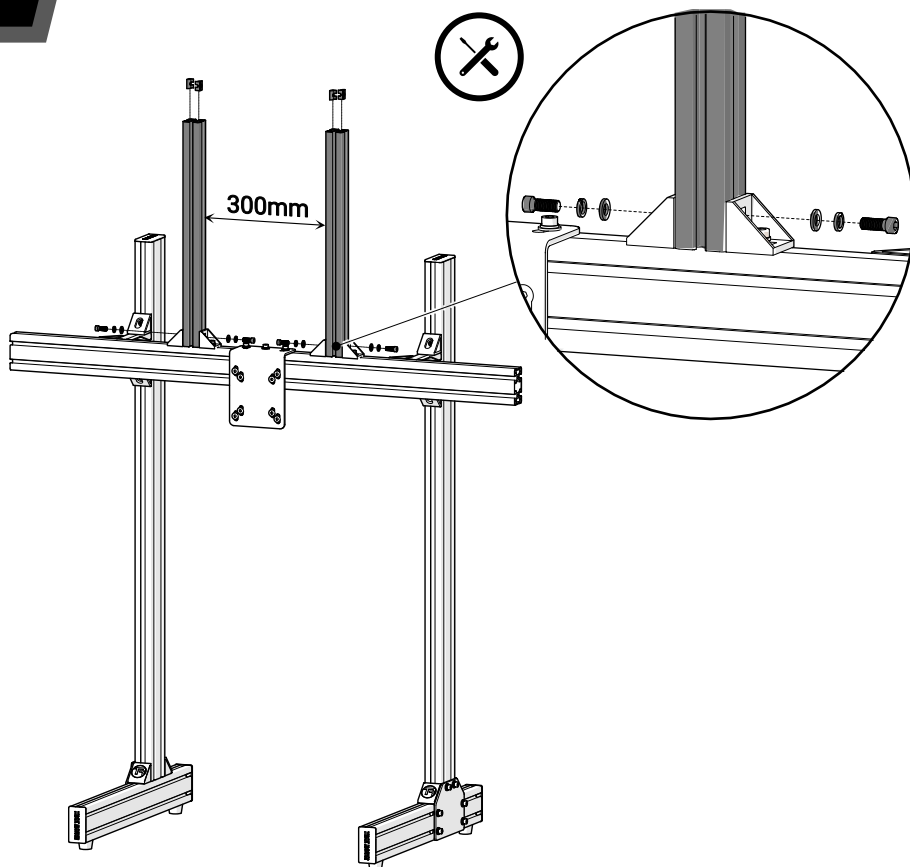

20



BT-01 x2

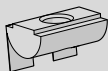

NS-M8 x8



M8x16mm

SH-M8-16 x8



WL-M8 x8



WF-M8 x8

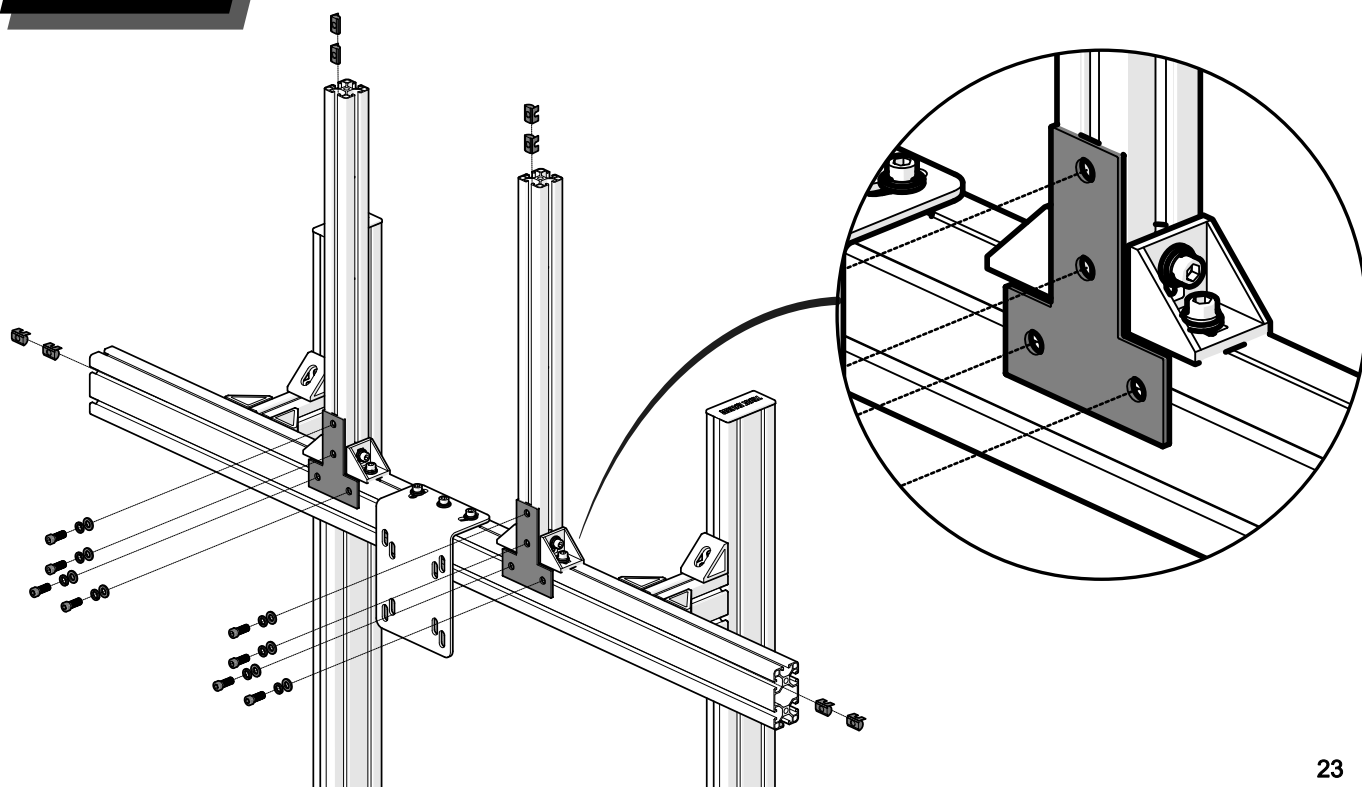

21

BM-QA x4 NS-M8 x4 SH-M8-20 x4 WL-M8 x4 WF-M8 x4

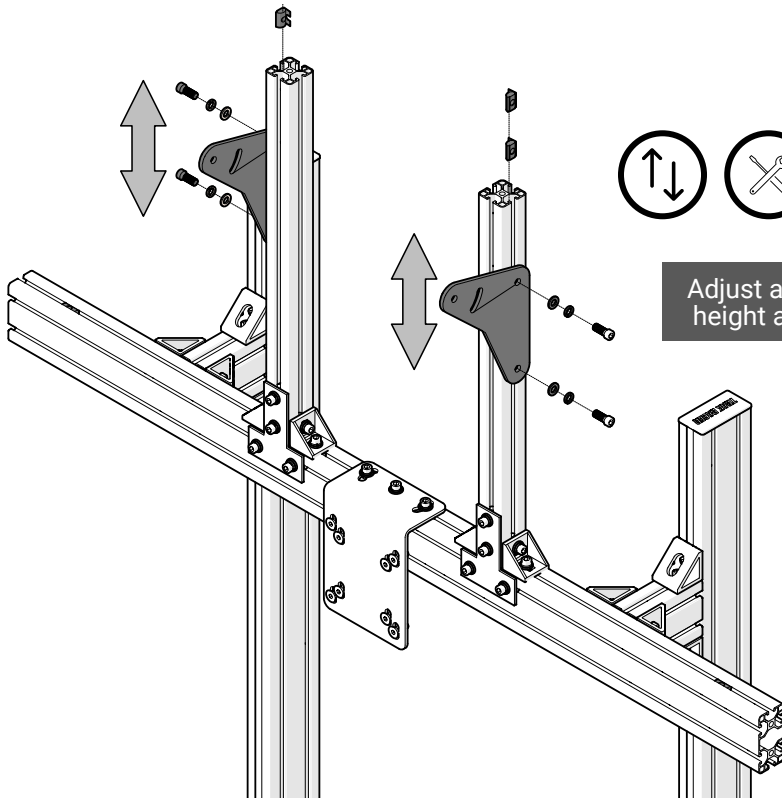

22

AL-40-400 x2 NS-M8 x4 SH-M8-20 x4 WL-M8 x4 WF-M8 x4 EC-40 x2

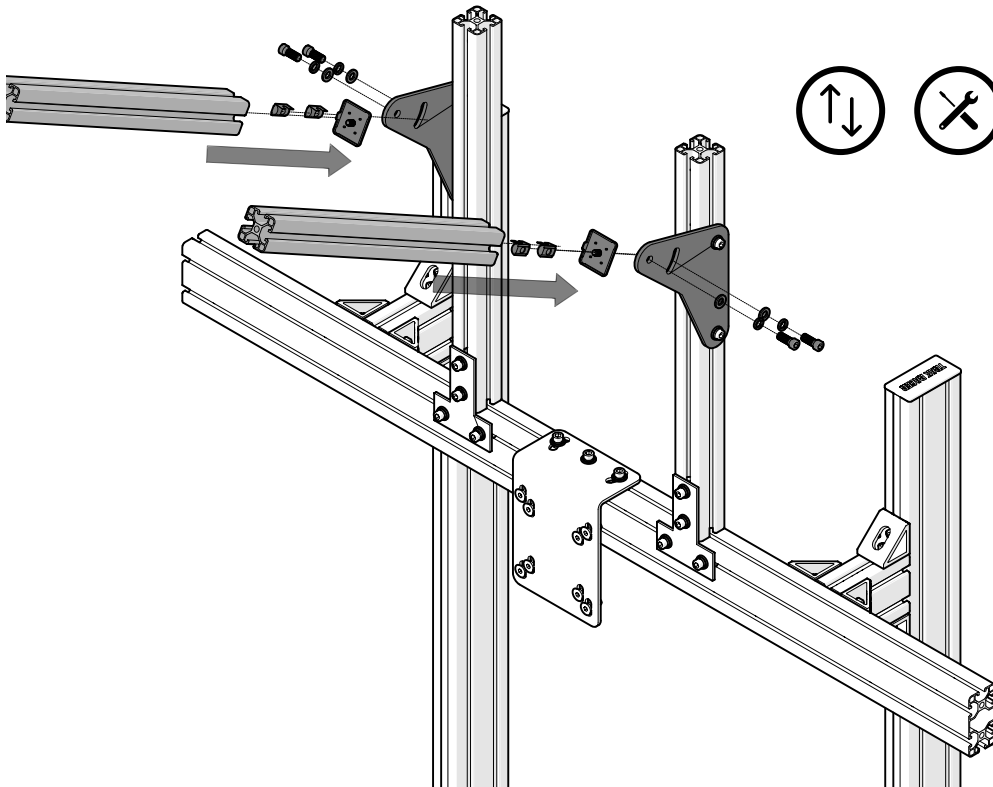

23



AL-40-300 x1



VM-02 x1

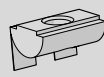

NS-M8 x7

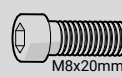

M8x20mm

SH-M8-20 x3



WL-M8 x3



WF-M8 x3

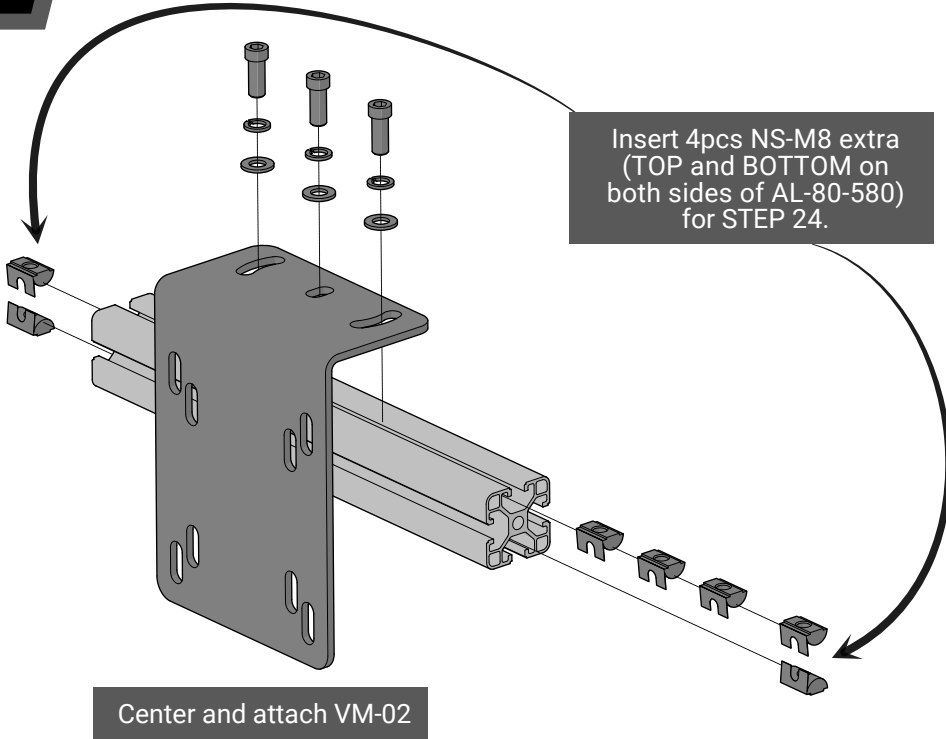

24

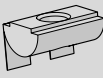

NS-M8 x4

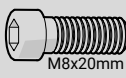

M8x20mm

SH-M8-20 x8



WL-M8 x8



WF-M8 x8



BC-40 x4

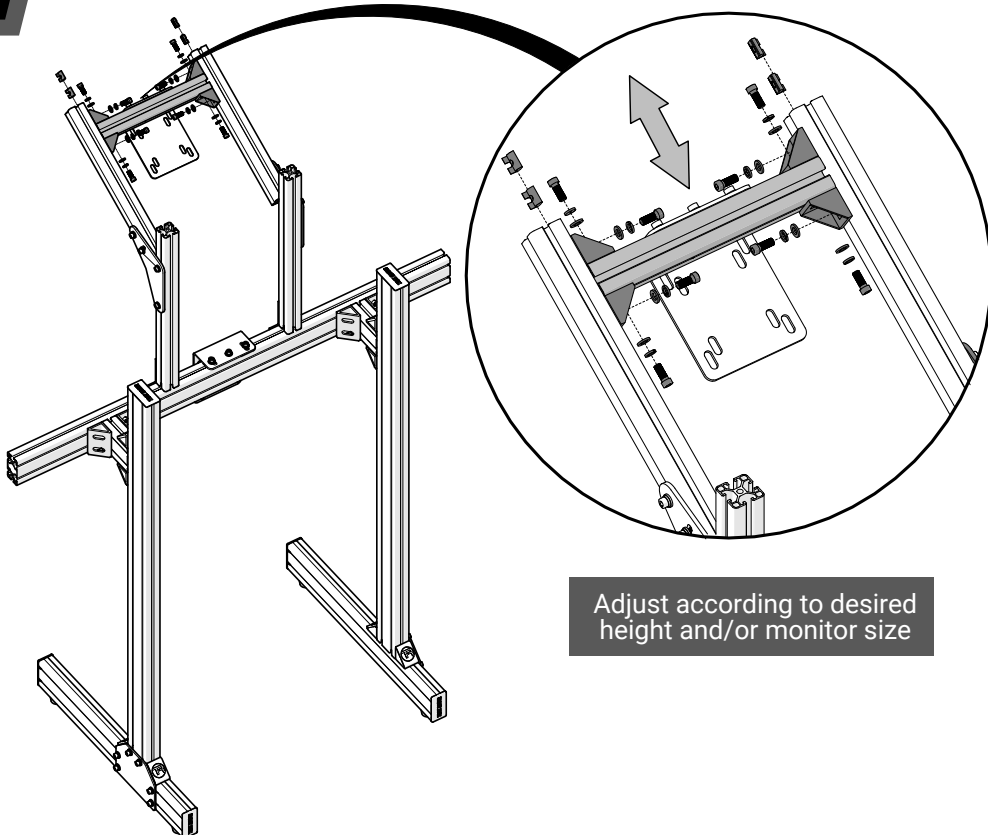

25

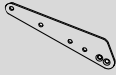

VM-02-A x2

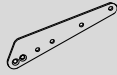

VM-02-B x2



SF-M8-16 x8



NF-M8 x8

NOTE: Optional for larger monitors.

If monitor mounting points are 150mm or 200mm apart, add VESA extensions (VM-02-E)

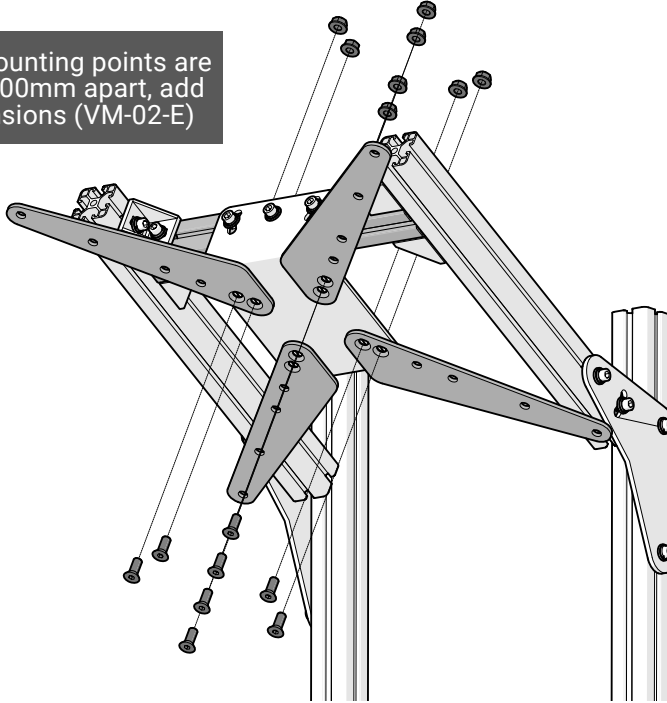

26



EC-40 x4



BC-40 x8

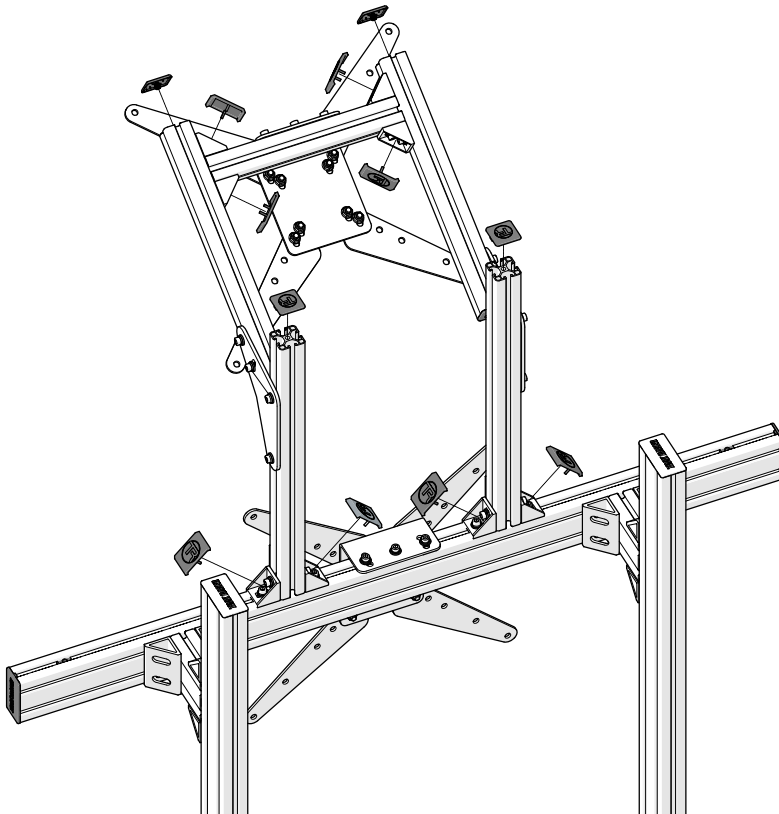



IMPORTANT: If your monitor screws are under 8mm (M8), you will need to use washers (not supplied)

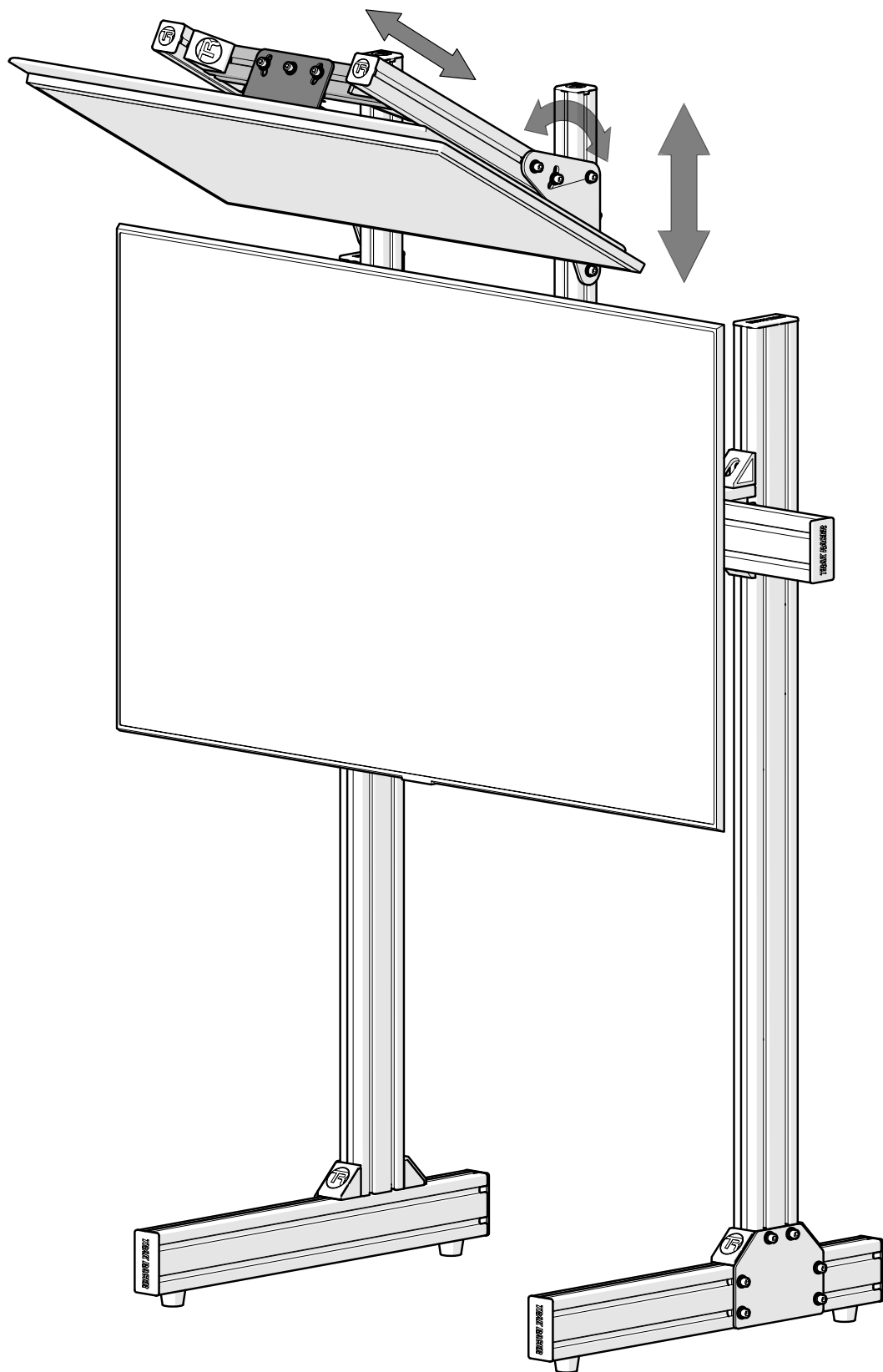

FINISHED



Share your build online and tag us to be featured!



@trakracer



@trakracer



@trak_racer